



### thermoMETER CTlaserGLASS

*Innovative precision infrared temperature sensor marking the actual spot size on your measurement target at any distance with 5.2  $\mu\text{m}$  wavelength for glass targets*

- Measuring range from 100°C to 1650°C
- Accurate glass temperature measurements on flat glass lines, container glass machines, bulb manufacturing, car glass finishing and the production of solar panels
- Cooling and protection accessories for harsh environmental conditions available
- Real mapping of the actual spot size, with automatic laser protection
- Precision optics (45:1 / 70:1) with different models for a specific focus point
- Extreme small measurement spot down to 1mm
- Up to 85°C ambient temperature without cooling
- Fully programmable instrument for enhanced signal processing and I/O control
- Separate controller with easy accessible programming keys and multi colour LCD backlit display

#### Optical specifications thermoMETER CTlaserGLASS

□ = smallest spot size (mm)

Standard Focus optics																
<b>SF45L 45:1</b>	20	20.8	21.7	22.5	23.4	24.2	25	25.9	27	32.5	38.4	50	61.7	73.4		
<b>SF70H 70:1</b>	20	19.6	19.3	19	18.5	18.2	17.8	17.4	17	21.6	26.3	35.5	44.8	54		
distance in mm	0	150	300	450	600	750	900	1050	1200	1350	1500	1800	2100	2400		
Close Focus optics																
<b>CF1L 45:1</b>	20	9.5	7	1.6	11	26.3	41.7	57	72.6	88.2	104	1196	135	165	196	227
<b>CF1H 70:1</b>	20	9	6.5	1	10	25	40	55	70	85	100	115	130	160	190	220
<b>CF2L 45:1</b>	20	16	14.5	12	9	3.4	11.2	19	27	35	42.5	50.3	58	73.6	89.2	105
<b>CF2H 70:1</b>	20	15.5	14	11	8	2.2	9.6	17	24.5	42	39.2	47	54	69	84	99
<b>CF3L 45:1</b>	20	17	16.2	14.5	12.3	8.4	4.5	10.7	16.8	23	29	35	41.3	53.5	65.8	78
<b>CF3H 70:1</b>	20	16.9	16	14	11	7.2	2.9	8.7	14.4	20	25.6	31.2	37.3	48.7	60.2	71.6
<b>CF4L 45:1</b>	20	19.2	19	18.6	18	17	15.6	14.5	13.4	12.3	11.1	10	13.4	20	26.7	33.4
<b>CF4H 70:1</b>	20	18.9	18.5	17.8	17	15.5	14	12.5	11	9.5	8	6.5	9.5	15.4	21.2	27.1
distance in mm	0	40	50	70	100	150	200	250	300	350	400	450	500	600	700	800

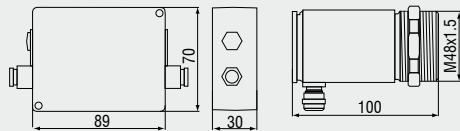

### Product identification

#### CTLG - SF45L - C3

Cable length [3 m Standard / 8 m / 15 m]  
 Focus [SF45L / SF70H / CF1L/H / CF2L/H / CF3L/H / CF4L/H]  
 thermoMETER CTLaserGLASS

Model		CTLG-SF45L-C3	CTLG-SF70H-C3
Optical resolution		45:1	70:1
Temperature range <sup>1</sup>		100 to 1200°C	250 to 1650°C
Spectral range		5,2µm	
System accuracy <sup>2</sup>		±1% or ±1°C	
Repeatability <sup>2</sup>		±0.5% or ±0.5°C	
Temperature resolution		0.1°C	0.2°C
Response time (90% signal)		120ms	80ms
Emissivity/gain <sup>1</sup>		0.100 to 1.100	
Transmissivity/gain <sup>1</sup>		0.100 to 1.000	
Signal processing <sup>1</sup>		peak hold, valley hold, average; extended hold function with threshold and hysteresis	
Certificate of calibration		optional	
Outputs/analogue	channel 1 channel 2 optional	0/4 to 20mA, 0 to 5/10V, thermocouple J, K sensor temperature (-40 to 85°C as 0 to 5V or 0 to 10V), alarm output relay: 2 x 60VDC/ 42VACeff; 0.4A; optically isolated	
Alarm output		open - collector (24V/ 50mA)	
Outputs/digital	optional	USB, RS232, RS485, CAN, Profibus DP, Ethernet	
Output impedances	current output voltage output	mA max. 500Ω (bei 5 to 36VDC) mV min. 100kΩ load impedance; thermocouple 20Ω	
Inputs		programmable functional inputs for external emissivity adjustment, ambient temperature compensation, trigger (reset of hold functions)	
Cable length		3m (standard), 8m, 15m	
Power supply		8 to 36VDC; max. 160mA	
Laser		class II (635nm), 1mW, ON/OFF via controller or software	
Environmental rating		IP 65 (NEMA-4)	
Ambient temperature		sensor: -20°C to 85°C (50°C if Laser is ON) controller: 0°C to 85°C	
Storage temperature		sensor: -40°C to 85°C controller: -40°C to 85°C	
Relative humidity		10 to 95%, non condensing	
Vibration	sensor	IEC 68-2-6: 3 G, 11 to 200Hz, any axis	
Shock	sensor	IEC 68-2-27: 50 G, 11 ms, any axis	
Weight		sensor: 600g; controller: 420g	

<sup>1</sup> adjustable via controller or software

<sup>2</sup> ± ambient temperature: 23 ±5°C; whichever is greater

### Accessories page 28 - 29

- ▶ Mounting bracket
- ▶ Air purge collar
- ▶ Rail mount adapter for controller
- ▶ Water cooled housing
- ▶ Interface kit
- ▶ Software CompactConnect
- ▶ Certificate of calibration



**LASER RADIATION**  
 DO NOT STARE IN THE BEAM  
 CLASS 2 LASER  
 EN60825-1:2002  
 P≤1mW; λ=630-650nm

**Controller**

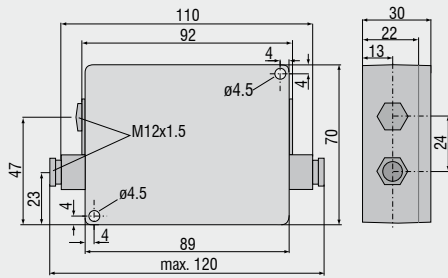

**CTLaser / CTLaserFAST / CTLaserGLASS / CTLaserM1/M2 / CTLaserM3 / CTLaserCOMBUSTION**

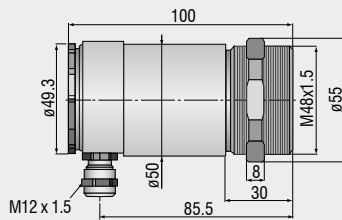

**CTratioM1**

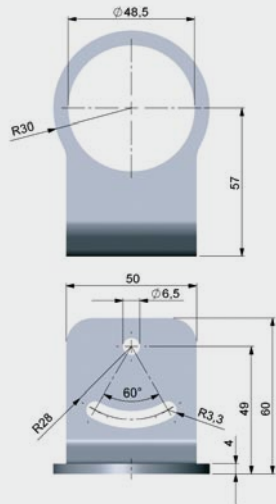
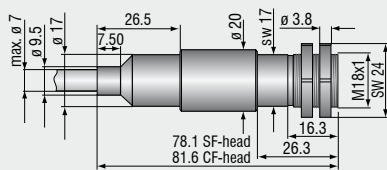

TM-FB-CTL Mounting bracket (fixed); included with CTL sensors

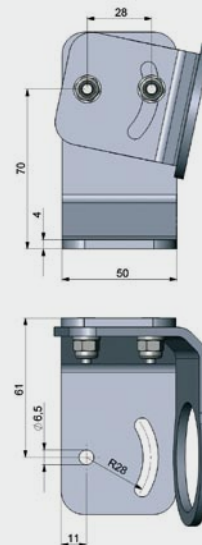

TM-AB-CTL Mounting bracket (adjustable)



TM-W-CTL Water cooled housing and air purge collar TM-AP-CTL, mounted on adjustable mounting bracket TM-AB-CTL

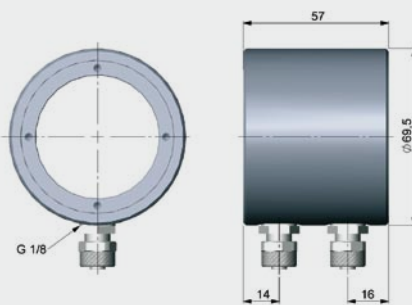

TM-W-CTL Water cooled housing

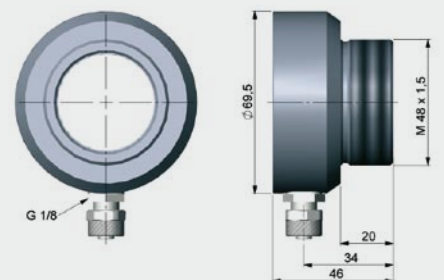

TM-AP-CTL Air purge collar

**Mechanical accessories**

Art. No.	Model	
2970238	TM-AB-CTL	Mounting bracket, adjustable, stainless steel
2970239	TM-AP-CTL	Air purge collar, stainless steel
2970240	TM-W-CTL	Water cooled housing, stainless steel, for ambient temperatures up to 175°C
2970241	TM-RAIL-CTL	Rail mount adapter for CTlaser controller
2970242	TM-COV-CTL	Closed cover for controller
2970243	TM-MN-CTL	Mounting nut, stainless steel (spare)
2970244	TM-FB-CTL	Mounting bracket, fixed, stainless steel (spare)
2970298	TM-A20UN-CTL	Screw adapter M48x1 on 20UN-2A screw including mounting nut



TM-J-CTL Cooling jacket (length 228mm, ø89mm) with adjustable mounting bracket TM-JAB-CTL; up to 315°C ambient temperature

**High temperature accessories**

2970366	TM-J-CTL	Cooling jacket (length 228mm, ø89mm) (connection kit TM-CONK-CTL is required)
2970374	TM-CONK-CTL	Connection kit: sensor with axial cable exit, for integration in cooling jacket
2970368	TM-JAB-CTL	Adjustable mounting bracket for cooling jacket
2970369	TM-MF-CTL	Mounting flange M48x1.5 for mounting a CTL sensor
2970370	TM-AST300-CTL	Sighting tube M48x1.5, 300 mm length
2970371	TM-PA-CTL	Pipe adapter M48x1.5
2970372	TM-RM-CTL	Furnace wall mount accessory for CTlaser (TM-MF-CTL, TM-AST300-CTL and TM-PA-CTL)



TM-MF-CTL Mounting flange M48x1.5 for mounting a CTL sensor

**Calibration**

2970253	TM-CERT-CTL	Certificate of calibration
2970324	TM-HTCERT-CTL	Certificate of calibration for CTlaser M1-/M2-/M3-/G-

**Interfaces**

2970245	TM-USBK-CTL	USB interface kit incl. computer cable, software CompactConnect
2970246	TM-RS232K-CTL	RS232 interface kit incl. computer cable, software CompactConnect
2970338	TM-RS485USBK-CTL	RS485-USB-adapter, incl. PC cable, RS485 board, software CTconnect, terminal block, for use with TM-485B-CTL
2970248	TM-RS485B-CTL	RS485 interface board
2970249	TM-CANK-CTL	CAN-Bus interface for optris CT/ protocol: CANopen Presettings: module address 20 (14H), 250kBaud, 0-60°C
2970250	TM-PFBDPK-CTL	Profibus-DPV1 interface for CT selectable with DIN M12 or SUB-D connection
2970251	TM-ETHNK-CTL	Ethernet-Kit: interface board, external Ethernet adapter, software CompactConnect
2970252	TM-RI-CTL	Relay interface: Two optically isolated relays, 60VDC/ 42VACRMS, 0.4A



TM-RM-CTL Furnace wall mount accessory for CTlaser / CTratio: TM-MF-CTL, TM-AST300-CTL und TM-PA-CTL

**Sensor cables and high temperature cables**

2970374	TM-CONK-CTL	Connector-Kit for cables with connector
4800254.003	TM-CB3C-CTL	Sensor cable with adapter (3m)
4800254.003H	TM-CB3HC-CTL	High-temperature sensor cable with adapter (3m)
4800254.008	TM-CB8C-CTL	Sensor cable with adapter (8m)
4800254.008H	TM-CB8HC-CTL	High-temperature sensor cable with adapter (8m)
4800254.015	TM-CB15C-CTL	Sensor cable with adapter (15m)
4800254.015H	TM-CB15HC-CTL	High-temperature sensor cable with adapter (15m)

**CTratio**

Art. No.	Model	
2970348	TM-FB-CTR	Mounting bracket, adjustable in one axis
2970349	TM-AB-CTR	Mounting bracket, adjustable in two axes
2970395	TM-AP-CTR	Air purge collar
2970373	TM-RM-CTR	Furnace wall mount accessory for CTratio