

# ASCO™ Pneumatic Angle Seat Valves

2-way, Pressure Operated, Stainless Steel Body, Plastic or Stainless Steel Actuator  
17.2 to 76.1 O.D. Stub, Butt Welding Body

2/2  
Series  
**290**

## Features and Benefits

- Special design of the valve prevents external build up and is easy to clean
- All wetted parts are available for contact with food in compliance with the EC Directive 1935/2004 and FDA CFR21
- Exhaust air can be easily ducted to reduce emissions and protect the environment
- Specifications are laser marked on the valve to prevent loss during high pressure washing
- Ample fluid passage for optimal flow
- Adjustable actuator enables 360° access to pilot port
- Modular design provides exceptional flexibility
- Anti-water hammer design and back pressure resistant
- Extensive range of actuators, options, certifications and accessories

## General

Differential pressure	See Specifications section [1 bar = 100 kPa]
Vacuum	10 <sup>-2</sup> mbar (10 <sup>-2</sup> Torr/mm Hg)
Maximum allowable pressure	16 bar (240 psi)
Ambient temperature range	
Plastic actuator	-10°C to +60°C (14°F to 140°F)
Stainless steel actuator	-20°C to +70°C (-4°F to 158°F)
Maximum viscosity	800 cSt (mm <sup>2</sup> /s) (2.700 SSU)
Pilot fluid	Filtered air or water
Maximum pilot pressure	10 bar (150 psi) / bistable function: 8 bar (120 psi)
Minimum pilot pressure	See Specifications section
Response time	See dedicated pilot catalog pages

Fluids (*)	Temperature range (TS) <sup>(1)</sup>	Disc seal (*)
Up to DN 50: air and gas groups 1 and 2	Plastic actuator: -10°C to +184°C (14°F to 360°F)	PTFE
All DN: liquids and steam groups 1 and 2	Stainless steel actuator: -20°C to 140°C (-4°F to 184°F)	
	WSF option: -10°C to +184°C (14°F to 360°F)	

## Materials of components in contact with fluid

(\*) Ensure that compatibility of materials in contact with fluids is verified.

	Plastic and stainless steel actuators	All 316L grade version with body passivation
Body	Stainless steel AISI 316L	Stainless steel AISI 316L
Stuffing box housing	Stainless steel AISI 316L	Stainless steel AISI 316L
Stem	Stainless steel AISI 431	Stainless steel AISI 316L
Disc	Stainless steel AISI 316L	Stainless steel AISI 316L
Disc seal	PTFE	PTFE
Wiper seal	FPM	FPM
Stuffing box packing	PTFE	PTFE
Valve body seal	PTFE	PTFE
Butt welding connection	AISI 316L (NET-INOX treatment / for all 316L grade version) ISO 1127 (page 2) DIN EN 10357-A (DIN 11850-S2) (page 6) SMS 3008 (page 8) ASME BPE (page 11) Brass or stainless steel AISI 316L	
Pilot port insert		

## Other components

Actuator	Glass fiber filled PA or stainless steel AISI 316L
Optical position indicator	PA 12

## Certifications and Approvals

- Pressure Equipment Directive 2014/68/EU, Category 1 (DN > 25) or article 4.3 (DN ≤ 25)
- Functional Safety of Machinery: EN ISO 13849-1
- Reach compliant
- IEC 61508 Standard (2010 route 2<sub>H</sub> version) certified with integrity levels: SIL 2 for HFT = 0
- The valves satisfy all relevant EU and EAC directives
- RoHS compatible

<sup>(1)</sup> The minimum ambient temperature of the valve is determined by the limitations of minimum temperature indicated.

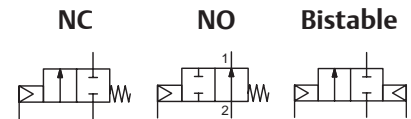

NC function, entry under the disc, 63 mm plastic actuator

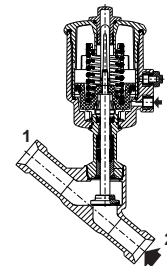

NO function, entry under the disc, 63 mm stainless steel actuator

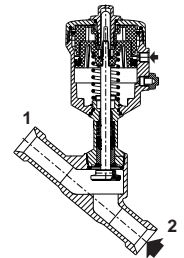

NC function, entry above the disc, 63 mm plastic actuator

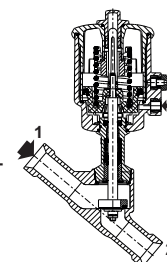

Bistable function, 63 mm stainless steel actuator

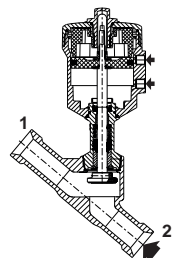

**Options <sup>(1)</sup>**

- Food contact certified: Wetted parts EC 1935/2004 and FDA CFR21
- Oxygen service pressure limited to 15 bar (220 psi), ambient and media temperatures limited to +60°C (140°F)
- Explosive atmospheres, ATEX and IECEx compliant
- Medium vacuum service up to 10<sup>-3</sup> mb (10<sup>-3</sup> Torr)
- Visual position indicator for 32 mm and 50 mm plastic actuators (standard position indicators for other plastic actuator sizes and stainless steel actuators)
- Pilots (see dedicated catalog pages)
- Large range of switch boxes and digital positioners (see dedicated catalog pages)
- Valve body material composition certificate 3.1

<sup>(1)</sup> See Choice of options and accessories (page 19)

**Specifications (Butt welding ISO 1127)**

O.D. of stub	I.D. of stub	DN	Flow coefficient		Pilot pressure bar (psi)		Operating pressure differential			Actuator diameter mm	Dimensions / Type <sup>(2)</sup>	Pilot connection	Catalog number			
							bar (psi)						Butt welding ISO 1127			
			m <sup>3</sup> /h (gal/min)	(l/min)	Min.	Max.	Air, inert gas (*)	Water, oil, liquids (*)	Steam <sup>(1)</sup> ≤ 140°C (≤ 284°F) (*)				Stainless steel body		Plastic actuator	Stainless steel actuator
<b>NC - Normally closed, entry under the disc</b>																
17.2	14	10	2.5 (2.9)	41	4.7 (75)	10 (150)	16 (240)	16 (240)	10 (150)	32	01	G*	W290D011WSA0000	W290D01PWSA0000		
									NPT			W290D012WSA0000	W290D01QWSA0000			
21.3	18.1	15	4.7 (5.4)	78	4.7 (75)	10 (150)	10 (150)	10 (150)	10 (150)	32	01	G*	W290D021WSA0000	W290D02PWSA0000		
									NPT			W290D022WSA0000	W290D02QWSA0000			
			5.4 (6.2)	90	4.5 (70)	10 (150)	16 (240)	16 (240)	10 (150)	50	02	G*	W290D023WSA0000	W290D02RWSA0000		
												NPT <sup>(3)</sup>	W290D024WSA0000	W290D02SWSA0000		
			2.8 (45)	10 (150)	16 (240)	16 (240)	10 (150)	63	03	G*	W290D025WSA0000	W290D02TWSA0000				
							NPT <sup>(3)</sup>			W290D026WSA0000	W290D02UWSA0000					
26.9	23.7	20	7.5 (8.7)	125	4.7 (75)	10 (150)	6 (90)	6 (90)	6 (90)	32	01	G*	W290D031WSA0000	W290D03PWSA0000		
									NPT <sup>(3)</sup>			W290D032WSA0000	W290D03QWSA0000			
			6.8 (7.9)	113	4.5 (70)	10 (150)	10 (150)	10 (150)	10 (150)	50	02	G*	W290D033WSA0000	W290D03RWSA0000		
												NPT <sup>(3)</sup>	W290D034WSA0000	W290D03SWSA0000		
							4.5 (70)	10 (150)	16 (240)	16 (240)	10 (150)	63	03	G*	W290D035WSA0000	W290D03TWSA0000
											NPT <sup>(3)</sup>			W290D036WSA0000	W290D03UWSA0000	
			2.8 (45)	10 (150)	12 (180)	12 (180)	10 (150)	63	03	G*	W290D735WSA0000	W290D73TWSA0000				
							NPT <sup>(3)</sup>			W290D736WSA0000	W290D73UWSA0000					
33.7	29.7	25	12.9 (15)	215	4.5 (70)	10 (150)	6 (90)	6 (90)	6 (90)	50	02	G*	W290D043WSA0000	W290D04RWSA0000		
									NPT <sup>(3)</sup>			W290D044WSA0000	W290D04SWSA0000			
			14.9 (17.3)	248	4.5 (70)	10 (150)	10 (150)	10 (150)	10 (150)	63	03	G*	W290D045WSA0000	W290D04TWSA0000		
									NPT <sup>(3)</sup>			W290D046WSA0000	W290D04UWSA0000			
			15.4 (17.8)	256	4.5 (70)	10 (150)	16 (240)	16 (240)	10 (150)	90	04	G*	W290D048WSA0000	W290D04XWSA0000		
									NPT <sup>(3)</sup>			W290D04CWSA0000	W290D04YWSA0000			
14.9 (17.3)	248	2.8 (45)	10 (150)	6 (90)	6 (90)	6 (90)	63	03	G*	W290D745WSA0000	W290D74TWSA0000					
									NPT <sup>(3)</sup>	W290D746WSA0000	W290D74UWSA0000					
15.4 (17.8)	256	2.8 (45)	10 (150)	12 (180)	12 (180)	10 (150)	90	04	G*	W290D748WSA0000	W290D74XWSA0000					
									NPT <sup>(3)</sup>	W290D74CWSA0000	W290D74YWSA0000					

(\*) Ensure that compatibility of materials in contact with fluids is verified.

<sup>(1)</sup> Only with stainless steel actuator.

<sup>(2)</sup> For dimensions, see drawing(s) for each construction type on the following page(s).

<sup>(3)</sup> Plastic actuator: NPTF / Stainless steel actuator: NPT

01537GB-2021/RO1  
Availability, design and specifications are subject to change without notice. All rights reserved.

## Specifications (Butt welding ISO 1127)

O.D. of stub	I.D. of stub	DN	Flow coefficient		Pilot pressure		Operating pressure differential			Actuator diameter	Dimensions / Type <sup>(2)</sup>	Pilot connection	Catalog number			
							bar (psi)						Butt welding ISO 1127			
			m <sup>3</sup> /h (gal/min)	l/min	Min.	Max.	Air, inert gas (*)	Water, oil, liquids (*)	Steam <sup>(1)</sup> ≤ 140°C (≤ 284°F) (*)				Plastic actuator	Stainless steel actuator		
42.4	38.4	32	27.3 (31.6)	455	4.5 (70)	10 (150)	6 (90)	6 (90)	6 (90)	63	03	G*	W290D055WSA0000	W290D05TWSA0000		
													NPT <sup>(3)</sup>	W290D056WSA0000	W290D05UWSA0000	
			28.5 (33)	475	4.5 (70)	10 (150)	12 (180)	12 (180)	10 (150)		90	04	G*	W290D05BWSA0000	W290D05XWSA0000	
														NPT <sup>(3)</sup>	W290D05CWSA0000	W290D05YWSA0000
			27.3 (31.6)	455	2.8 (45)	10 (150)	3 (45)	3 (45)	3 (45)		63	03	G*	W290D755WSA0000	W290D75TWSA0000	
													NPT <sup>(3)</sup>	W290D756WSA0000	W290D75UWSA0000	
		28.5 (33)	475	2.8 (45)	10 (150)	7 (105)	7 (105)	7 (105)		90	04	G*	W290D75BWSA0000	W290D75XWSA0000		
													NPT <sup>(3)</sup>	W290D75CWSA0000	W290D75YWSA0000	
		32.3 (37.5)	538	4 (60)	10 (150)	16 (240)	16 (240)	10 (150)		125	05	G*	W290D05HWSA0000	-		
													NPT <sup>(3)</sup>	W290D05JWSA0000	-	
48.3	44.3	40	33.7 (39)	561	4.5 (70)	10 (150)	4 (60)	4 (60)	4 (60)	63	03	G*	W290D065WSA0000	W290D06TWSA0000		
													NPT <sup>(3)</sup>	W290D066WSA0000	W290D06UWSA0000	
			35.4 (41)	590	4.5 (70)	10 (150)	8 (120)	8 (120)	8 (120)		90	04	G*	W290D06BWSA0000	W290D06XWSA0000	
														NPT <sup>(3)</sup>	W290D06CWSA0000	W290D06YWSA0000
			40.2 (46.6)	670	4 (60)	10 (150)	16 (240)	16 (240)	10 (150)		125	05	G*	W290D06HWSA0000	-	
													NPT <sup>(3)</sup>	W290D06JWSA0000	-	
		35.4 (41)	590	2.8 (45)	10 (150)	4 (58)	4 (58)	4 (58)		90	04	G*	W290D76BWSA0000	W290D76XWSA0000		
													NPT <sup>(3)</sup>	W290D76CWSA0000	W290D76YWSA0000	
		40.2 (46.6)	670	2.5 (40)	10 (150)	10 (150)	10 (150)	10 (150)		125	05	G*	W290D76HWSA0000	-		
													NPT <sup>(3)</sup>	W290D76JWSA0000	-	
60.3	56.3	50	51 (59.1)	850	4.5 (70)	10 (150)	2.5 (40)	2.5 (40)	2.5 (40)	63	03	G*	W290D075WSA0000	W290D07TWSA0000		
													NPT <sup>(3)</sup>	W290D076WSA0000	W290D07UWSA0000	
			55.1 (63.8)	918	4.5 (70)	10 (150)	6 (90)	6 (90)	6 (90)		90	04	G*	W290D07BWSA0000	W290D07XWSA0000	
														NPT <sup>(3)</sup>	W290D07CWSA0000	W290D07YWSA0000
			70.4 (81.6)	1173	4 (60)	10 (150)	10 (150)	10 (150)	10 (150)		125	05	G*	W290D07HWSA0000	-	
													NPT <sup>(3)</sup>	W290D07JWSA0000	-	
				2.5 (40)	10 (150)	5 (75)	5 (75)	5 (75)		125	05	G*	W290D77HWSA0000	-		
													NPT <sup>(3)</sup>	W290D77JWSA0000	-	
		90.4 (104.8)	1506	4.5 (70)	10 (150)	2 (30)	2 (30)	2 (30)		90	04	G*	W290D08BWSA0000	W290D08XWSA0000		
													NPT <sup>(3)</sup>	W290D08CWSA0000	W290D08YWSA0000	
109.1 (126.5)	1818	4 (60)	10 (150)	6 (90)	6 (90)	6 (90)		125	05	G*	W290D08HWSA0000	-				
											NPT <sup>(3)</sup>	W290D08JWSA0000	-			
<b>NO - Normally open, entry under the disc</b>																
17.2	14	10	2.5 (2.9)	41	IX (*)	10 (150)	16 (240)	16 (240)	10 (150)	32	01	G*	W290D111WSA0000	W290D11PWSA0000		
													NPT	W290D112WSA0000	W290D11QWSA0000	
21.3	18.1	15	4.7 (5.4)	78	IX (*)	10 (150)	16 (240)	16 (240)	10 (150)	32	01	G*	W290D121WSA0000	W290D12PWSA0000		
													NPT	W290D122WSA0000	W290D12QWSA0000	
		5.4 (6.2)	90	I (*)	10 (150)	16 (240)	16 (240)	10 (150)		50	02	G*	W290D123WSA0000	W290D12RWSA0000		
				II (*)	10 (150)	16 (240)	16 (240)	10 (150)		63	03	G*	W290D124WSA0000	W290D12SWSA0000		
											NPT <sup>(3)</sup>	W290D125WSA0000	W290D12TWSA0000			
											NPT <sup>(3)</sup>	W290D126WSA0000	W290D12UWSA0000			

(\*) Ensure that compatibility of materials in contact with fluids is verified.

(\*) Minimum pilot pressure varies with differential pressure, see page 18

<sup>(1)</sup> Only with stainless steel actuator.

<sup>(2)</sup> For dimensions, see drawing(s) for each construction type on the following page(s).

<sup>(3)</sup> Plastic actuator: NPTF / Stainless steel actuator: NPT

01537GB-2021/R01 Availability, design and specifications are subject to change without notice. All rights reserved.

**Specifications (Butt welding ISO 1127)**

O.D. of stub	I.D. of stub	DN	Flow coefficient		Pilot pressure		Operating pressure differential			Actuator diameter / Dimensions / Type <sup>(2)</sup>	Pilot connection	Catalog number				
			Kv (Cv)	m <sup>3</sup> /h (gal/min) / (l/min)	bar (psi)		Air, inert gas (*)	Water, oil, liquids (*)	Steam <sup>(1)</sup> ≤ 140°C (≤ 284°F) (*)			Butt welding ISO 1127				
					Min.	Max.						Plastic actuator	Stainless steel actuator			
26.9	23.7	20	7.5 (8.7)	125	IX(*)	10 (150)	16 (240)	16 (240)	10 (150)	32	01	G*	W290D131WSA0000	W290D13PWSA0000		
												NPT	W290D132WSA0000	W290D13QWSA0000		
			6.8 (7.9)	113	I(*)	10 (150)	16 (240)	16 (240)	10 (150)	50	02	G*	W290D133WSA0000	W290D13RWSA0000		
												NPT <sup>(3)</sup>	W290D134WSA0000	W290D13SWSA0000		
					II(*)	10 (150)	16 (240)	16 (240)	10 (150)	63	03	G*	W290D135WSA0000	W290D13TWSA0000		
												NPT <sup>(3)</sup>	W290D136WSA0000	W290D13UWSA0000		
33.7	29.7	25	12.9 (15)	215	I(*)	10 (150)	16 (240)	16 (240)	10 (150)	50	02	G*	W290D143WSA0000	W290D14RWSA0000		
												NPT <sup>(3)</sup>	W290D144WSA0000	W290D14SWSA0000		
			14.9 (17.3)	248	II(*)	10 (150)	16 (240)	16 (240)	10 (150)	63	03	G*	W290D145WSA0000	W290D14TWSA0000		
												NPT <sup>(3)</sup>	W290D146WSA0000	W290D14UWSA0000		
			15.4 (17.8)	256	III(*)	10 (150)	16 (240)	16 (240)	10 (150)	90	04	G*	W290D148WSA0000	W290D14XWSA0000		
												NPT <sup>(3)</sup>	W290D14CWSA0000	W290D14YWSA0000		
42.4	38.4	32	27.3 (31.6)	455	II(*)	10 (150)	16 (240)	16 (240)	10 (150)	63	03	G*	W290D155WSA0000	W290D15TWSA0000		
												NPT <sup>(3)</sup>	W290D156WSA0000	W290D15UWSA0000		
			28.5 (33)	475	III(*)	10 (150)	16 (240)	16 (240)	10 (150)	90	04	G*	W290D158WSA0000	W290D15XWSA0000		
												NPT <sup>(3)</sup>	W290D15CWSA0000	W290D15YWSA0000		
			32.3 (37.4)	538	IV(*)	10 (150)	16 (240)	16 (240)	10 (150)	125	05	G*	W290D15HWSA0000	-		
												NPT <sup>(3)</sup>	W290D15JWSA0000	-		
48.3	44.3	40	33.7 (39)	561	II(*)	10 (150)	11 (160)	11 (160)	10 (150)	63	03	G*	W290D165WSA0000	W290D16TWSA0000		
												NPT <sup>(3)</sup>	W290D166WSA0000	W290D16UWSA0000		
			35.4 (41)	590	III(*)	10 (150)	16 (240)	16 (240)	10 (150)	90	04	G*	W290D168WSA0000	W290D16XWSA0000		
												NPT <sup>(3)</sup>	W290D16CWSA0000	W290D16YWSA0000		
			40.2 (46.6)	670	IV(*)	10 (150)	16 (240)	16 (240)	10 (150)	125	05	G*	W290D16HWSA0000	-		
												NPT <sup>(3)</sup>	W290D16JWSA0000	-		
60.3	56.3	50	51 (59.1)	850	II(*)	10 (150)	7 (105)	7 (105)	7 (105)	63	03	G*	W290D175WSA0000	W290D17TWSA0000		
												NPT <sup>(3)</sup>	W290D176WSA0000	W290D17UWSA0000		
			55.1 (63.8)	918	III(*)	10 (150)	13 (200)	13 (200)	10 (150)	90	04	G*	W290D178WSA0000	W290D17XWSA0000		
												NPT <sup>(3)</sup>	W290D17CWSA0000	W290D17YWSA0000		
			70.4 (81.6)	1173	IV(*)	10 (150)	16 (240)	16 (240)	10 (150)	125	05	G*	W290D17HWSA0000	-		
												NPT <sup>(3)</sup>	W290D17JWSA0000	-		
76.1	72.1	65	90.4 (104.8)	1506	III(*)	10 (150)	7 (105)	7 (105)	7 (105)	90	04	G*	W290D188WSA0000	W290D18XWSA0000		
												NPT <sup>(3)</sup>	W290D18CWSA0000	W290D18YWSA0000		
			109.1 (126.5)	1818	IV(*)	10 (150)	16 (240)	16 (240)	10 (150)	125	05	G*	W290D18HWSA0000	-		
												NPT <sup>(3)</sup>	W290D18JWSA0000	-		
			<b>NC - Normally closed, entry above the disc (version recommended for rapid-cycling steam applications)</b>													
			17.2	14	10	2.7 (3.1)	45	X(*)	10 (150)	10 (150)	-	10 (150)	32	01	G*	W290D311WSA0000
NPT	W290D312WSA0000	W290D31QWSA0000														
21.3	18.1	15	5 (5.8)	83	X(*)	10 (150)	10 (150)	-	10 (150)	32	01	G*	W290D321WSA0000	W290D32PWSA0000		
												NPT	W290D322WSA0000	W290D32QWSA0000		
			4.8 (5.5)	80	V(*)	10 (150)	10 (150)	-	10 (150)	50	02	G*	W290D323WSA0000	W290D32RWSA0000		
												NPT <sup>(3)</sup>	W290D324WSA0000	W290D32SWSA0000		
			4.8 (5.5)	80	VI(*)	10 (150)	10 (150)	-	10 (150)	63	03	G*	W290D325WSA0000	W290D32TWSA0000		
												NPT <sup>(3)</sup>	W290D326WSA0000	W290D32UWSA0000		

(\*) Ensure that compatibility of materials in contact with fluids is verified.  
 (\*) Minimum pilot pressure varies with differential pressure, see page 18  
<sup>(1)</sup> Only with stainless steel actuator.  
<sup>(2)</sup> For dimensions, see drawing(s) for each construction type on the following page(s).  
<sup>(3)</sup> Plastic actuator: NPTF / Stainless steel actuator: NPT

## Specifications (Butt welding ISO 1127)

O.D. of stub	I.D. of stub	DN	Flow coefficient		Pilot pressure		Operating pressure differential			Actuator diameter	Dimensions / Type <sup>(2)</sup>	Pilot connection	Catalog number	
							bar (psi)						Butt welding ISO 1127	
			Kv (Cv)	(l/min)	Min.	Max.	Air, inert gas (*)	Water, oil, liquids (*)	Steam <sup>(1)</sup> ≤ 140°C (≤ 284°F) (*)				(mm)	Plastic actuator
26.9	23.7	20	7.8 (9)	130	X (*)	10 (150)	10 (150)	-	10 (150)	32	01	G*	W290D331WSA0000	W290D33PWSA0000
			7.2 (8.3)	120	V (*)	10 (150)	10 (150)	-	10 (150)	50	02	G*	W290D333WSA0000	W290D33RWSA0000
					VI (*)	10 (150)	10 (150)	-	10 (150)	63	03	NPT <sup>(3)</sup>	W290D334WSA0000	W290D33SWSA0000
						G*	W290D335WSA0000	W290D33TWSA0000						
33.7	29.7	25	13.2 (15.3)	220	V (*)	10 (150)	10 (150)	-	10 (150)	50	02	G*	W290D343WSA0000	W290D34RWSA0000
			15.9 (18.4)	265	VI (*)	10 (150)	10 (150)	-	10 (150)	63	03	NPT <sup>(3)</sup>	W290D344WSA0000	W290D34SWSA0000
						G*	W290D345WSA0000	W290D34TWSA0000						
					NPT <sup>(3)</sup>	W290D346WSA0000	W290D34UWSA0000							
42.4	38.4	32	28.3 (32.8)	471	VI (*)	10 (150)	10 (150)	-	10 (150)	63	03	G*	W290D355WSA0000	W290D35TWSA0000
			25.4 (29.4)	423	VII (*)	10 (150)	10 (150)	-	10 (150)	90	04	G*	W290D35BWSA0000	W290D35XWSA0000
						NPT <sup>(3)</sup>	W290D356WSA0000	W290D35UWSA0000						
					G*	W290D35CWSA0000	W290D35YWSA0000							
48.3	43.3	40	37.9 (44)	631	VI (*)	10 (150)	10 (150)	-	10 (150)	63	03	G*	W290D365WSA0000	W290D36TWSA0000
			31.9 (37)	531	VII (*)	10 (150)	10 (150)	-	10 (150)	90	04	G*	W290D366WSA0000	W290D36UWSA0000
						NPT <sup>(3)</sup>	W290D367WSA0000	W290D36VWSA0000						
					G*	W290D368WSA0000	W290D36XWSA0000							
60.3	56.3	50	56 (65)	933	VI (*)	10 (150)	9 (135)	-	9 (135)	63	03	G*	W290D375WSA0000	W290D37TWSA0000
			49 (56.8)	816	VII (*)	10 (150)	10 (150)	-	10 (150)	90	04	G*	W290D376WSA0000	W290D37UWSA0000
						NPT <sup>(3)</sup>	W290D377WSA0000	W290D37VWSA0000						
					G*	W290D378WSA0000	W290D37XWSA0000							
76.1	72.1	65	67.8 (78.6)	1130	VII (*)	10 (150)	10 (150)	-	10 (150)	90	04	G*	W290D388WSA0000	W290D38XWSA0000
						10 (150)	10 (150)	-	10 (150)	90	04	NPT <sup>(3)</sup>	W290D389WSA0000	W290D38YWSA0000
						G*	W290D390WSA0000	W290D391WSA0000						
					NPT <sup>(3)</sup>	W290D392WSA0000	W290D393WSA0000							
<b>Bistable function (version recommended for high fast cycling)</b>														
17.2	14	10	2.5 (2.9)	41	XII (*)	8 (120)	10 (150)	10 (150)	-	32	01	G*	W290D411WSA0000	W290D41PWSA0000
												NPT	W290D412WSA0000	W290D41QWSA0000
21.3	18.1	15	4.7 (5.4)	78	XII (*)	8 (120)	10 (150)	10 (150)	-	32	01	G*	W290D421WSA0000	W290D42PWSA0000
												NPT	W290D422WSA0000	W290D42QWSA0000
			5.4 (6.2)	90	X (*)	8 (120)	10 (150)	10 (150)	-	50	02	G*	W290D423WSA0000	W290D42RWSA0000
						NPT <sup>(3)</sup>	W290D424WSA0000	W290D42SWSA0000						
					XI (*)	8 (120)	10 (150)	10 (150)	-	63	03	G*	W290D425WSA0000	W290D42TWSA0000
						NPT <sup>(3)</sup>	W290D426WSA0000	W290D42UWSA0000						
26.9	23.7	20	7.5 (8.7)	125	XII (*)	8 (120)	10 (150)	10 (150)	-	32	01	G*	W290D431WSA0000	W290D43PWSA0000
												NPT	W290D432WSA0000	W290D43QWSA0000
			6.8 (7.9)	113	X (*)	8 (120)	10 (150)	10 (150)	-	50	02	G*	W290D433WSA0000	W290D43RWSA0000
						NPT <sup>(3)</sup>	W290D434WSA0000	W290D43SWSA0000						
					XI (*)	8 (120)	10 (150)	10 (150)	-	63	03	G*	W290D435WSA0000	W290D43TWSA0000
						NPT <sup>(3)</sup>	W290D436WSA0000	W290D43UWSA0000						
33.7	29.7	25	12.9 (15)	215	X (*)	8 (120)	10 (150)	10 (150)	-	50	02	G*	W290D443WSA0000	W290D44RWSA0000
												NPT <sup>(3)</sup>	W290D444WSA0000	W290D44SWSA0000
			14.9 (17.3)	248	XI (*)	8 (120)	10 (150)	10 (150)	-	63	03	G*	W290D445WSA0000	W290D44TWSA0000
												NPT <sup>(3)</sup>	W290D446WSA0000	W290D44UWSA0000

(\*) Ensure that compatibility of materials in contact with fluids is verified.

(\*) Minimum pilot pressure varies with differential pressure, see page 18

<sup>(1)</sup> Only with stainless steel actuator.

<sup>(2)</sup> For dimensions, see drawing(s) for each construction type on the following page(s).

<sup>(3)</sup> Plastic actuator: NPTF / Stainless steel actuator: NPT

01537GB-2021/R01 Availability, design and specifications are subject to change without notice. All rights reserved.

**Specifications (Butt welding SMS 3008)**

O.D. of stub	I.D. of stub	DN	Flow coefficient		Pilot pressure		Operating pressure differential			Actuator diameter / Dimensions / Type <sup>(1)</sup>	Pilot connection	Catalog number				
			Kv (Cv)	m <sup>3</sup> /h (gal/min) (l/min)	bar (psi)		Air, inert gas (*)	Water, oil, liquids (*)	Steam <sup>(1)</sup> ≤ 140°C (≤ 284°F) (*)			Butt welding SMS 3008				
					Min.	Max.						Plastic actuator	Stainless steel actuator			
<b>NC - Normally closed, entry under the disc</b>																
25	22.6	25	12.9 (15)	215	4.5 (70)	10 (150)	6 (90)	6 (90)	6 (90)	50	02	G*	W290D0432SA0000	W290D04R2SA0000		
													NPT <sup>(3)</sup>	W290D0442SA0000	W290D04S2SA0000	
			14.9 (17.3)	248	4.5 (70)	10 (150)	10 (150)	10 (150)	10 (150)	63	03	G*	W290D0452SA0000	W290D04T2SA0000		
														NPT <sup>(3)</sup>	W290D0462SA0000	W290D04U2SA0000
			15.4 (17.8)	256	4.5 (70)	10 (150)	16 (240)	16 (240)	10 (150)	90	04	G*	W290D04B2SA0000	W290D04X2SA0000		
											NPT <sup>(3)</sup>	W290D04C2SA0000	W290D04Y2SA0000			
			14.9 (17.3)	248	2.8 (45)	10 (150)	6 (90)	6 (90)	6 (90)	63	03	G*	W290D7452SA0000	W290D74T2SA0000		
												NPT <sup>(3)</sup>	W290D7462SA0000	W290D74U2SA0000		
			15.4 (17.8)	256	2.8 (45)	10 (150)	12 (180)	12 (180)	10 (150)	90	04	G*	W290D74B2SA0000	W290D74X2SA0000		
												NPT <sup>(3)</sup>	W290D74C2SA0000	W290D74Y2SA0000		
33.7	31.3	32	27.3 (31.6)	455	4.5 (70)	10 (150)	6 (90)	6 (90)	6 (90)	63	03	G*	W290D0552SA0000	W290D05T2SA0000		
													NPT <sup>(3)</sup>	W290D0562SA0000	W290D05U2SA0000	
			28.5 (33)	475	4.5 (70)	10 (150)	12 (180)	12 (180)	10 (150)	90	04	G*	W290D05B2SA0000	W290D05X2SA0000		
														NPT <sup>(3)</sup>	W290D05C2SA0000	W290D05Y2SA0000
			27.3 (31.6)	455	2.8 (45)	10 (150)	3 (45)	3 (45)	3 (45)	63	03	G*	W290D7552SA0000	W290D75T2SA0000		
											NPT <sup>(3)</sup>	W290D7562SA0000	W290D75U2SA0000			
			28.5 (33)	475	2.8 (45)	10 (150)	7 (105)	7 (105)	7 (105)	90	04	G*	W290D75B2SA0000	W290D75X2SA0000		
												NPT <sup>(3)</sup>	W290D75C2SA0000	W290D75Y2SA0000		
			32.3 (37.5)	538	4 (60)	10 (150)	16 (240)	16 (240)	10 (150)	125	05	G*	W290D05H2SA0000	-		
												NPT <sup>(3)</sup>	W290D05J2SA0000	-		
38	35.6	40	33.7 (39)	561	4.5 (70)	10 (150)	4 (60)	4 (60)	4 (60)	63	03	G*	W290D0652SA0000	W290D06T2SA0000		
													NPT <sup>(3)</sup>	W290D0662SA0000	W290D06U2SA0000	
			35.4 (41)	590	4.5 (70)	10 (150)	8 (120)	8 (120)	8 (120)	90	04	G*	W290D06B2SA0000	W290D06X2SA0000		
														NPT <sup>(3)</sup>	W290D06C2SA0000	W290D06Y2SA0000
			40.2 (46.6)	670	4 (60)	10 (150)	16 (240)	16 (240)	10 (150)	125	05	G*	W290D06H2SA0000	-		
											NPT <sup>(3)</sup>	W290D06J2SA0000	-			
			35.4 (41)	590	2.8 (45)	10 (150)	4 (58)	4 (58)	4 (58)	90	04	G*	W290D76B2SA0000	W290D76X2SA0000		
												NPT <sup>(3)</sup>	W290D76C2SA0000	W290D76Y2SA0000		
			40.2 (46.6)	670	2.5 (40)	10 (150)	10 (150)	10 (150)	10 (150)	125	05	G*	W290D76H2SA0000	-		
												NPT <sup>(3)</sup>	W290D76J2SA0000	-		
51	48.6	50	51 (59.1)	850	4.5 (70)	10 (150)	2.5 (40)	2.5 (40)	2.5 (40)	63	03	G*	W290D0752SA0000	W290D07T2SA0000		
													NPT <sup>(3)</sup>	W290D0762SA0000	W290D07U2SA0000	
			55.1 (63.8)	918	4.5 (70)	10 (150)	6 (90)	6 (90)	6 (90)	90	04	G*	W290D07B2SA0000	W290D07X2SA0000		
														NPT <sup>(3)</sup>	W290D07C2SA0000	W290D07Y2SA0000
			70.4 (81.6)	1173	4 (60)	10 (150)	10 (150)	10 (150)	10 (150)	125	05	G*	W290D07H2SA0000	-		
											NPT <sup>(3)</sup>	W290D07J2SA0000	-			
												G*	W290D77H2SA0000	-		
												NPT <sup>(3)</sup>	W290D77J2SA0000	-		

(\*) Ensure that compatibility of materials in contact with fluids is verified.  
<sup>(1)</sup> Only with stainless steel actuator.  
<sup>(2)</sup> For dimensions, see drawing(s) for each construction type on the following page(s).  
<sup>(3)</sup> Plastic actuator: NPTF / Stainless steel actuator: NPT

## Specifications (Butt welding SMS 3008)

O.D. of stub	I.D. of stub	DN	Flow coefficient		Pilot pressure		Operating pressure differential			Actuator diameter (mm)	Dimensions / Type (1)	Piloting connection	Catalog number				
			Kv (Cv)	m <sup>3</sup> /h (gal/min)	Min.	Max.	bar (psi)						Butt welding SMS 3008				
							Air, inert gas (*)	Water, oil, liquids (*)	Steam (1) ≤ 140°C (≤ 284°F) (*)				Plastic actuator	Stainless steel actuator			
<b>NO - Normally open, entry under the disc</b>																	
25	22.6	25	12.9 (15)	215	I (*)	10 (150)	16 (240)	16 (240)	10 (150)	50	02	G*	W290D1432SA0000	W290D14R2SA0000			
			14.9 (17.3)	248	II (*)		16 (240)	16 (240)	10 (150)	63	03	G*	W290D1442SA0000	W290D14S2SA0000			
												NPT (3)	W290D1452SA0000	W290D14T2SA0000			
			15.4 (17.8)	256	III (*)		16 (240)	16 (240)	10 (150)	90	04	G*	W290D1462SA0000	W290D14U2SA0000			
												NPT (3)	W290D14B2SA0000	W290D14X2SA0000			
			27.3 (31.6)	455	II (*)		16 (240)	16 (240)	10 (150)	63	03	G*	W290D14C2SA0000	W290D14Y2SA0000			
NPT (3)	W290D152SA0000	W290D15T2SA0000															
28.5 (33)	475	III (*)	16 (240)	16 (240)	10 (150)	90	04	G*	W290D152SA0000	W290D15U2SA0000							
								NPT (3)	W290D15B2SA0000	W290D15X2SA0000							
32.3 (37.4)	538	IV (*)	16 (240)	16 (240)	10 (150)	125	05	G*	W290D15C2SA0000	W290D15Y2SA0000							
								NPT (3)	W290D15H2SA0000	-							
38	35.6	40	33.7 (39)	561	II (*)	10 (150)	11 (160)	11 (160)	10 (150)	63	03	G*	W290D162SA0000	W290D16T2SA0000			
			35.4 (41)	590	III (*)		16 (240)	16 (240)	10 (150)	90	04	G*	W290D162SA0000	W290D16U2SA0000			
												NPT (3)	W290D1662SA0000	W290D16V2SA0000			
			40.2 (46.6)	670	IV (*)		16 (240)	16 (240)	10 (150)	125	05	G*	W290D16C2SA0000	W290D16Y2SA0000			
												NPT (3)	W290D16H2SA0000	-			
			51	48.6	50		51 (59.1)	850	II (*)	10 (150)	7 (105)	7 (105)	7 (105)	63	03	G*	W290D16J2SA0000
55.1 (63.8)	918	III (*)				13 (200)	13 (200)	10 (150)	90		04	G*	W290D172SA0000	W290D17T2SA0000			
			NPT (3)	W290D1762SA0000	W290D17U2SA0000												
70.4 (81.6)	1173	IV (*)	16 (240)	16 (240)	10 (150)	125	05	G*	W290D17B2SA0000	W290D17X2SA0000							
								NPT (3)	W290D17C2SA0000	W290D17Y2SA0000							
-	-	-	-	-	-	-	-	-	-	-	-	G*	W290D17H2SA0000	-			
												NPT (3)	W290D17J2SA0000	-			
<b>NC - Normally closed, entry above the disc (version recommended for rapid-cycling steam applications)</b>																	
25	22.6	25	13.2 (15.3)	220	V (*)	10 (150)	10 (150)	-	10 (150)	50	02	G*	W290D3432SA0000	W290D34R2SA0000			
			15.9 (18.4)	265	VI (*)	10 (150)	10 (150)	-	10 (150)	63	03	G*	W290D3442SA0000	W290D34S2SA0000			
												NPT (3)	W290D3452SA0000	W290D34T2SA0000			
33.7	31.3	32	28.3 (32.8)	471	VI (*)	10 (150)	10 (150)	-	10 (150)	63	03	G*	W290D3462SA0000	W290D34U2SA0000			
			25.4 (29.4)	423	VII (*)	10 (150)	10 (150)	-	10 (150)	90	04	G*	W290D352SA0000	W290D35T2SA0000			
												NPT (3)	W290D3552SA0000	W290D35U2SA0000			
37.9 (44)	631	VI (*)	10 (150)	10 (150)	-	10 (150)	63	03	G*	W290D3562SA0000	W290D35V2SA0000						
									NPT (3)	W290D35B2SA0000	W290D35X2SA0000						
31.9 (37)	531	VII (*)	10 (150)	10 (150)	-	10 (150)	90	04	G*	W290D35C2SA0000	W290D35Y2SA0000						
									NPT (3)	W290D362SA0000	W290D36T2SA0000						
51	48.6	50	56 (65)	933	VI (*)	10 (150)	9 (135)	-	9 (135)	63	03	G*	W290D362SA0000	W290D36U2SA0000			
			49 (56.8)	816	VII (*)	10 (150)	10 (150)	-	10 (150)	90	04	G*	W290D36B2SA0000	W290D36X2SA0000			
												NPT (3)	W290D3662SA0000	W290D36V2SA0000			
			-	-	-	-	-	-	-	-	-	-	-	-	G*	W290D36C2SA0000	W290D36Y2SA0000
															NPT (3)	W290D372SA0000	W290D37T2SA0000
			-	-	-	-	-	-	-	-	-	-	-	-	-	G*	W290D3752SA0000
NPT (3)	W290D3762SA0000	W290D37V2SA0000															
-	-	-	-	-	-	-	-	-	-	-	-	-	G*	W290D3772SA0000	W290D37X2SA0000		
													NPT (3)	W290D37B2SA0000	W290D37Y2SA0000		
-	-	-	-	-	-	-	-	-	-	-	-	-	G*	W290D37C2SA0000	W290D37ZSA0000		
													NPT (3)	W290D3782SA0000	W290D37A2SA0000		

(\*) Ensure that compatibility of materials in contact with fluids is verified.

(\*) Minimum pilot pressure varies with differential pressure, see page 18

(1) Only with stainless steel actuator.

(2) For dimensions, see drawing(s) for each construction type on the following page(s).

(3) Plastic actuator: NPTF / Stainless steel actuator: NPT

01537GB-2021/R01 Availability, design and specifications are subject to change without notice. All rights reserved.

**Specifications (Butt welding DIN 11850 s2)**

O.D. of stub	I.D. of stub	DN	Flow coefficient		Pilot pressure		Operating pressure differential			Actuator diameter	Dimensions / Type (1)	Pilot connection	Catalog number	
							bar (psi)	Air, inert gas (*)	Water, oil, liquids (*)				Steam (1) ≤ 140°C (≤ 284°F) (*)	Butt welding DIN EN 10357-A (DIN 11850-S2) Stainless steel body
			m³/h (gal/min)	l/min	Min.	Max.								Plastic actuator
<b>NC - Normally closed, entry under the disc</b>														
19	16	15	5.4 (6.2)	90	4.5 (70)	10 (150)	16 (240)	16 (240)	10 (150)	50	02	G*	W290D0231SA0000	W290D02R1SA0000
					2.8 (45)	10 (150)	16 (240)	16 (240)	10 (150)			63	03	NPT (3)
					G*	W290D0251SA0000	W290D02T1SA0000							
					NPT (3)	W290D0261SA0000	W290D02U1SA0000							
23	20	20	6.8 (7.9)	113	4.5 (70)	10 (150)	10 (150)	10 (150)	10 (150)	50	02	G*	W290D0331SA0000	W290D03R1SA0000
					4.5 (70)	10 (150)	16 (240)	16 (240)	10 (150)			63	03	NPT (3)
					G*	W290D0351SA0000	W290D03T1SA0000							
					NPT (3)	W290D0361SA0000	W290D03U1SA0000							
					G*	W290D7351SA0000	W290D73T1SA0000							
					NPT (3)	W290D7361SA0000	W290D73U1SA0000							
					G*	W290D0431SA0000	W290D04R1SA0000							
					NPT (3)	W290D0441SA0000	W290D04S1SA0000							
29	26	25	12.9 (15)	215	4.5 (70)	10 (150)	6 (90)	6 (90)	6 (90)	50	02	G*	W290D0431SA0000	W290D04R1SA0000
			14.9 (17.3)	248	4.5 (70)	10 (150)	10 (150)	10 (150)	10 (150)			63	03	NPT (3)
			G*	W290D0451SA0000	W290D04T1SA0000									
			NPT (3)	W290D0461SA0000	W290D04U1SA0000									
			G*	W290D04B1SA0000	W290D04X1SA0000									
			NPT (3)	W290D04C1SA0000	W290D04Y1SA0000									
			G*	W290D7451SA0000	W290D74T1SA0000									
			NPT (3)	W290D7461SA0000	W290D74U1SA0000									
			G*	W290D74B1SA0000	W290D74X1SA0000									
			NPT (3)	W290D74C1SA0000	W290D74Y1SA0000									
35	32	32	27.3 (31.6)	455	4.5 (70)	10 (150)	6 (90)	6 (90)	6 (90)	63	03	G*	W290D0551SA0000	W290D05T1SA0000
			28.5 (33)	475	4.5 (70)	10 (150)	12 (180)	12 (180)	10 (150)			90	04	NPT (3)
			G*	W290D05B1SA0000	W290D05X1SA0000									
			NPT (3)	W290D05C1SA0000	W290D05Y1SA0000									
			G*	W290D7551SA0000	W290D75T1SA0000									
			NPT (3)	W290D7561SA0000	W290D75U1SA0000									
			G*	W290D75B1SA0000	W290D75X1SA0000									
			NPT (3)	W290D75C1SA0000	W290D75Y1SA0000									
			G*	W290D05H1SA0000	-									
			NPT (3)	W290D05J1SA0000	-									
41	38	40	33.7 (39)	561	4.5 (70)	10 (150)	4 (60)	4 (60)	4 (60)	63	03	G*	W290D0651SA0000	W290D06T1SA0000
			35.4 (41)	590	4.5 (70)	10 (150)	8 (120)	8 (120)	8 (120)			90	04	NPT (3)
			G*	W290D06B1SA0000	W290D06X1SA0000									
			NPT (3)	W290D06C1SA0000	W290D06Y1SA0000									
			G*	W290D06H1SA0000	-									
			NPT (3)	W290D06J1SA0000	-									
			G*	W290D76B1SA0000	W290D76X1SA0000									
			NPT (3)	W290D76C1SA0000	W290D76Y1SA0000									
			G*	W290D76H1SA0000	-									
			NPT (3)	W290D76J1SA0000	-									

(\*) Ensure that compatibility of materials in contact with fluids is verified.  
 (1) Only with stainless steel actuator.  
 (2) For dimensions, see drawing(s) for each construction type on the following page(s).  
 (3) Plastic actuator: NPTF / Stainless steel actuator: NPT



## Specifications (Butt welding DIN 11850 s2)

O.D. of stub	I.D. of stub	DN	Flow coefficient		Pilot pressure		Operating pressure differential			Actuator diameter / Dimensions / Type <sup>(1)</sup>	Piloting connection	Catalog number				
			Kv (Cv)	m <sup>3</sup> /h (gal/min) / (l/min)	bar (psi)		bar (psi)					Butt welding DIN EN 10357-A (DIN 11850-S2) Stainless steel body				
					Min.	Max.	Air, inert gas (*)	Water, oil, liquids (*)	Steam <sup>(1)</sup> ≤ 140°C (≤ 284°F) (*)			Plastic actuator	Stainless steel actuator			
53	50	50	51 (59.1)	850	4.5 (70)	10 (150)	2.5 (40)	2.5 (40)	2.5 (40)	63	03	G*	W290D0751SA0000	W290D07T1SA0000		
													NPT <sup>(3)</sup>	W290D0761SA0000	W290D07U1SA0000	
			55.1 (63.8)	918	4.5 (70)	10 (150)	6 (90)	6 (90)	6 (90)	90	04	G*	W290D07B1SA0000	W290D07X1SA0000		
													NPT <sup>(3)</sup>	W290D07C1SA0000	W290D07Y1SA0000	
			70.4 (81.6)	1173	4 (60)	10 (150)	10 (150)	10 (150)	10 (150)	125	05	G*	W290D07H1SA0000	-		
							2.5 (40)	10 (150)	5 (75)	5 (75)	5 (75)	125	05	NPT <sup>(3)</sup>	W290D07J1SA0000	-
<b>NO - Normally open, entry under the disc</b>																
19	16	15	5.4 (6.2)	90	I(*)	10 (150)	16 (240)	16 (240)	10 (150)	50	02	G*	W290D1231SA0000	W290D12R1SA0000		
					II(*)		16 (240)	16 (240)	10 (150)	63	03	NPT <sup>(3)</sup>	W290D1241SA0000	W290D12S1SA0000		
23	20	20	6.8 (7.9)	113	I(*)	10 (150)	16 (240)	16 (240)	10 (150)	50	02	G*	W290D1331SA0000	W290D13R1SA0000		
					II(*)		16 (240)	16 (240)	10 (150)	63	03	NPT <sup>(3)</sup>	W290D1341SA0000	W290D13S1SA0000		
29	26	25	12.9 (15)	215	I(*)	10 (150)	16 (240)	16 (240)	10 (150)	50	02	G*	W290D1431SA0000	W290D14R1SA0000		
													NPT <sup>(3)</sup>	W290D1441SA0000	W290D14S1SA0000	
			14.9 (17.3)	248	II(*)		16 (240)	16 (240)	10 (150)	63	03	G*	W290D1451SA0000	W290D14T1SA0000		
														NPT <sup>(3)</sup>	W290D1461SA0000	W290D14U1SA0000
			15.4 (17.8)	256	III(*)		16 (240)	16 (240)	10 (150)	90	04	G*	W290D14B1SA0000	W290D14X1SA0000		
														NPT <sup>(3)</sup>	W290D14C1SA0000	W290D14Y1SA0000
35	32	32	27.3 (31.6)	455	II(*)	10 (150)	16 (240)	16 (240)	10 (150)	63	03	G*	W290D1551SA0000	W290D15T1SA0000		
													NPT <sup>(3)</sup>	W290D1561SA0000	W290D15U1SA0000	
			28.5 (33)	475	III(*)		16 (240)	16 (240)	10 (150)	90	04	G*	W290D15B1SA0000	W290D15X1SA0000		
														NPT <sup>(3)</sup>	W290D15C1SA0000	W290D15Y1SA0000
			32.3 (37.4)	538	IV(*)		16 (240)	16 (240)	10 (150)	125	05	G*	W290D15H1SA0000	-		
											NPT <sup>(3)</sup>	W290D15J1SA0000	-			
41	38	40	33.7 (39)	561	II(*)	10 (150)	11 (160)	11 (160)	10 (150)	63	03	G*	W290D1651SA0000	W290D16T1SA0000		
													NPT <sup>(3)</sup>	W290D1661SA0000	W290D16U1SA0000	
			35.4 (41)	590	III(*)		16 (240)	16 (240)	10 (150)	90	04	G*	W290D16B1SA0000	W290D16X1SA0000		
														NPT <sup>(3)</sup>	W290D16C1SA0000	W290D16Y1SA0000
			40.2 (46.6)	670	IV(*)		16 (240)	16 (240)	10 (150)	125	05	G*	W290D16H1SA0000	-		
											NPT <sup>(3)</sup>	W290D16J1SA0000	-			
53	50	50	51 (59.1)	850	II(*)	10 (150)	7 (105)	7 (105)	7 (105)	63	03	G*	W290D1751SA0000	W290D17T1SA0000		
													NPT <sup>(3)</sup>	W290D1761SA0000	W290D17U1SA0000	
			55.1 (63.8)	918	III(*)		13 (200)	13 (200)	10 (150)	90	04	G*	W290D17B1SA0000	W290D17X1SA0000		
														NPT <sup>(3)</sup>	W290D17C1SA0000	W290D17Y1SA0000
			70.4 (81.6)	1173	IV(*)		16 (240)	16 (240)	10 (150)	125	05	G*	W290D17H1SA0000	-		
											NPT <sup>(3)</sup>	W290D17J1SA0000	-			

(\*) Ensure that compatibility of materials in contact with fluids is verified.

(\*) Minimum pilot pressure varies with differential pressure, see page 18

<sup>(1)</sup> Only with stainless steel actuator.

<sup>(2)</sup> For dimensions, see drawing(s) for each construction type on the following page(s).

<sup>(3)</sup> Plastic actuator: NPTF / Stainless steel actuator: NPT

**Specifications (Butt welding DIN 11850 s2)**

O.D. of stub	I.D. of stub	DN	Flow coefficient		Pilot pressure		Operating pressure differential			Actuator diameter	Dimensions / Type <sup>(1)</sup>	Piloting connection	Catalog number		
							bar (psi)						Air, inert gas (*)	Water, oil, liquids (*)	Steam <sup>(1)</sup> ≤ 140°C (≤ 284°F) (*)
			Kv (Cv)	m <sup>3</sup> /h (gal/min)	l/min	Min.	Max.	Plastic actuator	Stainless steel actuator						
<b>NC - Normally closed, entry above the disc (version recommended for rapid-cycling steam applications)</b>															
19	16	15	4.8 (5.5)	80	V(*)	10 (150)	10 (150)	-	10 (150)	50	02	G*	W290D3231SA0000	W290D32R1SA0000	
						10 (150)	10 (150)	-	10 (150)			NPT <sup>(3)</sup>	W290D3241SA0000	W290D32S1SA0000	
						VI(*)	10 (150)	10 (150)	-	10 (150)	63	03	G*	W290D3251SA0000	W290D32T1SA0000
							10 (150)	10 (150)	-	10 (150)			NPT <sup>(3)</sup>	W290D3261SA0000	W290D32U1SA0000
23	20	20	7.2 (8.3)	120	V(*)	10 (150)	10 (150)	-	10 (150)	50	02	G*	W290D3331SA0000	W290D33R1SA0000	
						10 (150)	10 (150)	-	10 (150)			NPT <sup>(3)</sup>	W290D3341SA0000	W290D33S1SA0000	
						VI(*)	10 (150)	10 (150)	-	10 (150)	63	03	G*	W290D3351SA0000	W290D33T1SA0000
							10 (150)	10 (150)	-	10 (150)			NPT <sup>(3)</sup>	W290D3361SA0000	W290D33U1SA0000
29	26	25	13.2 (15.3)	220	V(*)	10 (150)	10 (150)	-	10 (150)	50	02	G*	W290D3431SA0000	W290D34R1SA0000	
			15.9 (18.4)	265		10 (150)	10 (150)	-	10 (150)			NPT <sup>(3)</sup>	W290D3441SA0000	W290D34S1SA0000	
		VI(*)	10 (150)	10 (150)	-	10 (150)	63	03	G*	W290D3451SA0000	W290D34T1SA0000				
			10 (150)	10 (150)	-	10 (150)			NPT <sup>(3)</sup>	W290D3461SA0000	W290D34U1SA0000				
35	32	32	28.3 (32.8)	471	VI(*)	10 (150)	10 (150)	-	10 (150)	63	03	G*	W290D3551SA0000	W290D35T1SA0000	
			25.4 (29.4)	423		10 (150)	10 (150)	-	10 (150)			NPT <sup>(3)</sup>	W290D3561SA0000	W290D35U1SA0000	
		VII(*)	10 (150)	10 (150)	-	10 (150)	90	04	G*	W290D35B1SA0000	W290D35X1SA0000				
			10 (150)	10 (150)	-	10 (150)			NPT <sup>(3)</sup>	W290D35C1SA0000	W290D35Y1SA0000				
41	38	40	37.9 (44)	631	VI(*)	10 (150)	10 (150)	-	10 (150)	63	03	G*	W290D3651SA0000	W290D36T1SA0000	
			31.9 (37)	531		10 (150)	10 (150)	-	10 (150)			NPT <sup>(3)</sup>	W290D3661SA0000	W290D36U1SA0000	
		VII(*)	10 (150)	10 (150)	-	10 (150)	90	04	G*	W290D36B1SA0000	W290D36X1SA0000				
			10 (150)	10 (150)	-	10 (150)			NPT <sup>(3)</sup>	W290D36C1SA0000	W290D36Y1SA0000				
53	50	50	56 (65)	933	VI(*)	10 (150)	9 (135)	-	9 (135)	63	03	G*	W290D3751SA0000	W290D37T1SA0000	
			49 (56.8)	816		10 (150)	10 (150)	-	10 (150)			NPT <sup>(3)</sup>	W290D3761SA0000	W290D37U1SA0000	
		VII(*)	10 (150)	10 (150)	-	10 (150)	90	04	G*	W290D37B1SA0000	W290D37X1SA0000				
			10 (150)	10 (150)	-	10 (150)			NPT <sup>(3)</sup>	W290D37C1SA0000	W290D37Y1SA0000				

(\*) Ensure that compatibility of materials in contact with fluids is verified.  
 (\*) Minimum pilot pressure varies with differential pressure, see page 18  
<sup>(1)</sup> Only with stainless steel actuator.  
<sup>(2)</sup> For dimensions, see drawing(s) for each construction type on the following page(s).  
<sup>(3)</sup> Plastic actuator: NPTF / Stainless steel actuator: NPT

## Specifications (Butt welding ASME BPE)

O.D. of stub	I.D. of stub	DN	Flow coefficient		Pilot pressure		Operating pressure differential			Actuator diameter / Dimensions / Type <sup>(1)</sup>	Pilot connection	Catalog number			
			Kv (Cv)	m <sup>3</sup> /h (gal/min) (l/min)	bar (psi)		Air, inert gas (*)	Water, oil, liquids (*)	Steam <sup>(1)</sup> ≤ 140°C (≤ 284°F) (*)			Butt welding ASME BPE			
					Min.	Max.						Plastic actuator	Stainless steel actuator		
<b>NC - Normally closed, entry under the disc</b>															
9.53	7.75	10	1.9 (2.2)	31	4.7 (75)	10 (150)	16 (240)	16 (240)	10 (150)	32	01	G* W290D0113SA0000	W290D01P3SA0000		
												NPT W290D0123SA0000	W290D01Q3SA0000		
12.7	9.4	15	2.5 (2.9)	41	4.7 (75)	10 (150)	10 (150)	10 (150)	10 (150)	32	01	G* W290D0213SA0000	W290D02P3SA0000		
													NPT W290D0223SA0000	W290D02Q3SA0000	
			2.6 (3)	43	4.5 (70)	10 (150)	16 (240)	16 (240)	10 (150)	50	02	G* W290D0233SA0000	W290D02R3SA0000		
					2.8 (45)	10 (150)	16 (240)	16 (240)	10 (150)	63	03	NPT <sup>(3)</sup> W290D0243SA0000	W290D02S3SA0000		
												G* W290D0253SA0000	W290D02T3SA0000		
												NPT <sup>(3)</sup> W290D0263SA0000	W290D02U3SA0000		
19.05	15.75	20	4.7 (5.4)	78	4.7 (75)	10 (150)	6 (90)	6 (90)	6 (90)	32	01	G* W290D0313SA0000	W290D03P3SA0000		
													NPT <sup>(3)</sup> W290D0323SA0000	W290D03Q3SA0000	
			6.8 (7.9)	113	4.5 (70)	10 (150)	10 (150)	10 (150)	10 (150)	50	02	G* W290D0333SA0000	W290D03R3SA0000		
					2.8 (45)	10 (150)	12 (180)	12 (180)	10 (150)	63	03	NPT <sup>(3)</sup> W290D0343SA0000	W290D03S3SA0000		
												G* W290D0353SA0000	W290D03T3SA0000		
												NPT <sup>(3)</sup> W290D0363SA0000	W290D03U3SA0000		
25.4	22.1	25	12.9 (15)	215	4.5 (70)	10 (150)	6 (90)	6 (90)	6 (90)	50	02	G* W290D0433SA0000	W290D04R3SA0000		
													NPT <sup>(3)</sup> W290D0443SA0000	W290D04S3SA0000	
			14.9 (17.2)	248	4.5 (70)	10 (150)	10 (150)	10 (150)	10 (150)	63	03	G* W290D0453SA0000	W290D04T3SA0000		
														NPT <sup>(3)</sup> W290D0463SA0000	W290D04U3SA0000
			15.4 (17.8)	256	4.5 (70)	10 (150)	16 (240)	16 (240)	10 (150)	90	04	G* W290D0483SA0000	W290D04X3SA0000		
														NPT <sup>(3)</sup> W290D0493SA0000	W290D04Y3SA0000
												G* W290D7453SA0000	W290D74T3SA0000		
												NPT <sup>(3)</sup> W290D7463SA0000	W290D74U3SA0000		
												G* W290D7483SA0000	W290D74X3SA0000		
												NPT <sup>(3)</sup> W290D7493SA0000	W290D74Y3SA0000		
38.1	34.8	40	33.7 (39)	561	4.5 (70)	10 (150)	4 (60)	4 (60)	4 (60)	63	03	G* W290D0653SA0000	W290D06T3SA0000		
													NPT <sup>(3)</sup> W290D0663SA0000	W290D06U3SA0000	
			35.4 (41)	590	4.5 (70)	10 (150)	8 (120)	8 (120)	8 (120)	90	04	G* W290D0683SA0000	W290D06X3SA0000		
														NPT <sup>(3)</sup> W290D0693SA0000	W290D06Y3SA0000
			40.2 (46.6)	670	4 (60)	10 (150)	16 (240)	16 (240)	10 (150)	125	05	G* W290D06H3SA0000	-		
														NPT <sup>(3)</sup> W290D06J3SA0000	-
												G* W290D7683SA0000	W290D76X3SA0000		
												NPT <sup>(3)</sup> W290D7693SA0000	W290D76Y3SA0000		
												G* W290D76H3SA0000	-		
												NPT <sup>(3)</sup> W290D76J3SA0000	-		
50.8	47.5	50	51 (59.1)	850	4.5 (70)	10 (150)	2.5 (40)	2.5 (40)	2.5 (40)	63	03	G* W290D0753SA0000	W290D07T3SA0000		
													NPT <sup>(3)</sup> W290D0763SA0000	W290D07U3SA0000	
			55.1 (63.8)	918	4.5 (70)	10 (150)	6 (90)	6 (90)	6 (90)	90	04	G* W290D0783SA0000	W290D07X3SA0000		
														NPT <sup>(3)</sup> W290D0793SA0000	W290D07Y3SA0000
												G* W290D07H3SA0000	-		
												NPT <sup>(3)</sup> W290D07J3SA0000	-		
												G* W290D77H3SA0000	-		
												NPT <sup>(3)</sup> W290D77J3SA0000	-		

(\*) Ensure that compatibility of materials in contact with fluids is verified.

<sup>(1)</sup> Only with stainless steel actuator.

<sup>(2)</sup> For dimensions, see drawing(s) for each construction type on the following page(s).

<sup>(3)</sup> Plastic actuator: NPTF / Stainless steel actuator: NPT

01537GB-2021/R01 Availability, design and specifications are subject to change without notice. All rights reserved.

**Specifications (Butt welding ASME BPE)**

O.D. of stub	I.D. of stub	DN	Flow coefficient		Pilot pressure		Operating pressure differential			Actuator diameter / Dimensions / Type <sup>(1)</sup>	Pilot connection	Catalog number		
			Kv (Cv)	m <sup>3</sup> /h (gal/min) (l/min)	bar (psi)		bar (psi)					Butt welding ASME BPE		
					Min.	Max.	Air, inert gas (*)	Water, oil, liquids (*)	Steam <sup>(1)</sup> ≤ 140°C (≤ 284°F) (*)			Plastic actuator	Stainless steel actuator	
<b>NO - Normally open, entry under the disc</b>														
9.53	7.75	10	1.9 (2.2)	31	IX (*)	10 (150)	16 (240)	16 (240)	10 (150)	32	01	G* W290D1113SA0000	W290D11P3SA0000	
			2.5 (2.9)	41	IX (*)	10 (150)	16 (240)	16 (240)	10 (150)	32	01	NPT W290D1123SA0000	W290D11Q3SA0000	
12.7	9.4	15	2.6 (3)	43	I (*)	10 (150)	16 (240)	16 (240)	10 (150)	50	02	G* W290D1233SA0000	W290D12R3SA0000	
					II (*)	10 (150)	16 (240)	16 (240)	10 (150)	63	03	NPT <sup>(3)</sup> W290D1243SA0000	W290D12S3SA0000	
			6.8 (7.9)	113	I (*)	10 (150)	16 (240)	16 (240)	10 (150)	50	02	G* W290D1253SA0000	W290D12T3SA0000	
					II (*)	10 (150)	16 (240)	16 (240)	10 (150)	63	03	NPT <sup>(3)</sup> W290D1263SA0000	W290D12U3SA0000	
19.05	15.75	20	4.7 (5.4)	78	IX (*)	10 (150)	10 (150)	10 (150)	10 (150)	32	01	G* W290D1313SA0000	W290D13P3SA0000	
					NPT	W290D1323SA0000	W290D13Q3SA0000							
			6.8 (7.9)	113	I (*)	10 (150)	16 (240)	16 (240)	10 (150)	50	02	G* W290D1333SA0000	W290D13R3SA0000	
					II (*)	10 (150)	16 (240)	16 (240)	10 (150)	63	03	NPT <sup>(3)</sup> W290D1343SA0000	W290D13S3SA0000	
25.4	22.1	25	12.9 (15)	215	I (*)	10 (150)	16 (240)	16 (240)	10 (150)	50	02	G* W290D1433SA0000	W290D14R3SA0000	
					NPT	W290D1443SA0000	W290D14S3SA0000							
			14.9 (17.2)	248	II (*)	10 (150)	16 (240)	16 (240)	10 (150)	63	03	G* W290D1453SA0000	W290D14T3SA0000	
					NPT	W290D1463SA0000	W290D14U3SA0000							
15.4 (17.8)	256	III (*)	10 (150)	16 (240)	16 (240)	10 (150)	90	04	G* W290D14B3SA0000	W290D14X3SA0000				
		NPT	W290D14C3SA0000	W290D14Y3SA0000										
38.1	34.8	40	33.7 (39)	561	II (*)	10 (150)	11 (160)	11 (160)	10 (150)	63	03	G* W290D1653SA0000	W290D16T3SA0000	
					NPT	W290D1663SA0000	W290D16U3SA0000							
			35.4 (41)	590	III (*)	10 (150)	16 (240)	16 (240)	10 (150)	90	04	G* W290D16B3SA0000	W290D16X3SA0000	
					NPT	W290D16C3SA0000	W290D16Y3SA0000							
40.2 (46.6)	670	IV (*)	10 (150)	16 (240)	16 (240)	10 (150)	125	05	G* W290D16H3SA0000	-				
		NPT	W290D16J3SA0000	-										
50.8	47.5	50	51 (59.1)	850	II (*)	10 (150)	7 (105)	7 (105)	7 (105)	63	03	G* W290D1753SA0000	W290D17T3SA0000	
					NPT	W290D1763SA0000	W290D17U3SA0000							
			55.1 (63.8)	918	III (*)	10 (150)	13 (200)	13 (200)	10 (150)	90	04	G* W290D17B3SA0000	W290D17X3SA0000	
					NPT	W290D17C3SA0000	W290D17Y3SA0000							
70.4 (81.6)	1173	IV (*)	10 (150)	16 (240)	16 (240)	10 (150)	125	05	G* W290D17H3SA0000	-				
		NPT	W290D17J3SA0000	-										

(\*) Ensure that compatibility of materials in contact with fluids is verified.  
 (\*) Minimum pilot pressure varies with differential pressure, see page 18  
<sup>(1)</sup> Only with stainless steel actuator.  
<sup>(2)</sup> For dimensions, see drawing(s) for each construction type on the following page(s).  
<sup>(3)</sup> Plastic actuator: NPTF / Stainless steel actuator: NPT

## Specifications (Butt welding ASME BPE)

O.D. of stub	I.D. of stub	DN	Flow coefficient		Pilot pressure		Operating pressure differential			Actuator diameter / Dimensions / Type <sup>(1)</sup>	Pilot connection	Catalog number		
							bar (psi)					Butt welding ASME BPE		
			m <sup>3</sup> /h (gal/min)	l/min	Min.	Max.	Air, inert gas (*)	Water, oil, liquids (*)	Steam <sup>(1)</sup> ≤ 140°C (≤ 284°F) (*)			Plastic actuator	Stainless steel actuator	
<b>NC - Normally closed, entry above the disc (version recommended for rapid-cycling steam applications)</b>														
9.53	7.75	10	2 (2.3)	33	X(*)	10 (150)	10 (150)	-	10 (150)	32	01	G* W290D3113SA0000	W290D31P3SA0000	
												NPT W290D3123SA0000	W290D31Q3SA0000	
12.7	9.4	15	2.7 (3.1)	45	X(*)	10 (150)	10 (150)	-	10 (150)	32	01	G* W290D3213SA0000	W290D32P3SA0000	
													NPT W290D3223SA0000	W290D32Q3SA0000
			2.5 (2.9)	41	V(*)	10 (150)	10 (150)	-	10 (150)	50	02	G* W290D3233SA0000	W290D32R3SA0000	
													NPT <sup>(3)</sup> W290D3243SA0000	W290D32S3SA0000
			2.5 (2.9)	41	VI(*)	10 (150)	10 (150)	-	10 (150)	63	03	G* W290D3253SA0000	W290D32T3SA0000	
												NPT <sup>(3)</sup> W290D3263SA0000	W290D32U3SA0000	
19.5	15.75	20	5 (5.8)	83	X(*)	10 (150)	10 (150)	-	10 (150)	32	01	G* W290D3313SA0000	W290D33P3SA0000	
													NPT W290D3323SA0000	W290D33Q3SA0000
			7.2 (8.3)	120	V(*)	10 (150)	10 (150)	-	10 (150)	50	02	G* W290D3333SA0000	W290D33R3SA0000	
												NPT <sup>(3)</sup> W290D3343SA0000	W290D33S3SA0000	
			7.2 (8.3)	120	VI(*)	10 (150)	10 (150)	-	10 (150)	63	03	G* W290D3353SA0000	W290D33T3SA0000	
												NPT <sup>(3)</sup> W290D3363SA0000	W290D33U3SA0000	
25.4	22.1	25	13.2 (15.3)	220	V(*)	10 (150)	10 (150)	-	10 (150)	50	02	G* W290D3433SA0000	W290D34R3SA0000	
													NPT <sup>(3)</sup> W290D3443SA0000	W290D34S3SA0000
			15.9 (18.4)	265	VI(*)	10 (150)	10 (150)	-	10 (150)	63	03	G* W290D3453SA0000	W290D34T3SA0000	
												NPT <sup>(3)</sup> W290D3463SA0000	W290D34U3SA0000	
38.1	34.8	40	37.9 (44)	631	VI(*)	10 (150)	10 (150)	-	10 (150)	63	03	G* W290D3653SA0000	W290D36T3SA0000	
													NPT <sup>(3)</sup> W290D3663SA0000	W290D36U3SA0000
			31.9 (37)	531	VII(*)	10 (150)	10 (150)	-	10 (150)	90	04	G* W290D36B3SA0000	W290D36X3SA0000	
												NPT <sup>(3)</sup> W290D36C3SA0000	W290D36Y3SA0000	
50.8	47.5	50	56 (65)	933	VI(*)	10 (150)	9 (135)	-	9 (135)	63	03	G* W290D3753SA0000	W290D37T3SA0000	
													NPT <sup>(3)</sup> W290D3763SA0000	W290D37U3SA0000
			49 (56.8)	816	VII(*)	10 (150)	10 (150)	-	10 (150)	90	04	G* W290D37B3SA0000	W290D37X3SA0000	
												NPT <sup>(3)</sup> W290D37C3SA0000	W290D37Y3SA0000	

(\*) Ensure that compatibility of materials in contact with fluids is verified.

(\*) Minimum pilot pressure varies with differential pressure, see page 18

<sup>(1)</sup> Only with stainless steel actuator.

<sup>(2)</sup> For dimensions, see drawing(s) for each construction type on the following page(s).

<sup>(3)</sup> Plastic actuator: NPTF / Stainless steel actuator: NPT

**Product selection guide**

Configurator - CAD Files

**PRODUCT CODE**  
**W 290 D 0 3 1 0 S A00 00**

**Connection type**  
W= Butt welding

**Product series**  
290

**Revision letter**  
D = Initial release

**Function**  
0 = Normally Closed  
1 = Normally Open  
7 = Normally Closed - Low pilot pressure  
3 = Normally Closed - Above the disc  
4 = Double Acting (bistable)  
P = Normally closed with profil disc

**Nominal diameter**  
1 = DN10 - 3/8"  
2 = DN15 - 1/2"  
3 = DN20 - 3/4"  
4 = DN25 - 1"  
5 = DN32 - 1 1/4"  
6 = DN40 - 1 1/2"  
7 = DN50 - 2"  
8 = DN65 - 2 1/2"

**Actuator diameter - Piloting connections**  
1 = 32 mm plastic - G 1/8"  
2 = 32 mm plastic - NPTF 1/8"  
3 = 50 mm plastic - G 1/8"  
4 = 50 mm plastic - NPTF 1/8"  
5 = 63 mm plastic - G 1/8"  
6 = 63 mm plastic - NPTF 1/8"  
B = 90 mm plastic - G 1/4"  
C = 90 mm plastic - NPTF 1/4"  
H = 125 mm plastic - G 1/4"  
J = 125 mm plastic - NPTF 1/4"  
9 = 63 mm plastic - NAMUR plate<sup>(3)</sup>  
A = 90 mm plastic - NAMUR plate<sup>(3)</sup>  
F = 125 mm plastic - NAMUR plate<sup>(3)</sup>  
  
P = 32 mm stainless steel - G 1/8"  
Q = 32 mm stainless steel - NPT 1/8"  
R = 50 mm stainless steel - G 1/8"  
S = 50 mm stainless steel - NPT 1/8"  
T = 63 mm stainless steel - G 1/8"  
U = 63 mm stainless steel - NPT 1/8"  
X = 90 mm stainless steel - G 1/4"  
Y = 90 mm stainless steel - NPT 1/4"  
G = 50 mm stainless steel - NAMUR plate<sup>(3)</sup>  
W = 63 mm stainless steel - NAMUR plate<sup>(3)</sup>  
Z = 90 mm stainless steel - NAMUR plate<sup>(3)</sup>

<sup>(3)</sup> Solenoid pilot valves, series 551, 3/2 NC:  
- Aluminum body, catalog number **SCG551A001**  
- AISI 316L stainless steel body, catalog number **SCG551A40**

**Options**

- A00** = Without
- PFB** = Prepared for signaling box mounting<sup>(1)</sup>
- AT1** = ATEX/IECEx 1/21 zones<sup>(1)</sup>
- ATO** = ATEX/IECEx 0/20 zones<sup>(1)</sup>
- 02S** = Oxygen service 15 bar / 60°C
- LTP** = Low temperature down to -60°C (stainless steel actuator)
- 125** = CTR certification (EAC Ex 1/21 zones) for Product
- STL** = Stroke limiter for opening<sup>(1)</sup>
- TC6** = Test tightness class VI<sup>(1)</sup>
- VAC** = Industrial vacuum 10<sup>-3</sup> mbar<sup>(1)</sup>
- M31** = Stainless steel valve body material certified 3.1
- FBO** = EC 1935-2004 regulation and FDA CFR 21 material
- WSP** = PTFE wiper seal
- WSF** = FPM piston seal and steam using up to +184°C / 360°F
- 11B** = Manual safety device<sup>(1)</sup>
- V10** = Visual indicator<sup>(2)</sup>
- SSF** = Stainless steel insert for plastic actuator

**Valve body material**

- S** = Stainless steel body
- Y** = All 316L

**Port type 1-2**

- W** = Butt welding ISO 1127
- 1** = Butt welding DIN EN 10357-A (DIN 11850-S2)
- 2** = Butt welding SMS 3008
- 3** = Butt welding ASME BPE

<sup>(1)</sup> See "Choice of options and accessories", pages 19 and 20  
<sup>(2)</sup> For 32 mm and 50 mm plastic actuators (standard for 63 mm, 90 mm and 125 mm plastic actuators and all stainless steel actuators)

# ASCO™ Pneumatic Angle Seat Valves

## Repair Kits and Service Parts

### Butt welding ISO 1127

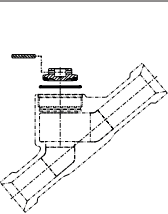
	Ø	DN	Spare parts kits no. 50-63-90-125 mm	
			entry under the disc	
			Normally Closed	Normally Open + Double Acting (bistable)
	1/2"	15	M29054935100800	M29054935103500
	3/4"	20	M29054935100900	M29054935103600
	1"	25	M29054935101000	M29054935103700
	1 1/4"	32	M29054935101100	M29054935105200
	1 1/2"	40	M29054935101200	M29054935105300
	2"	50	M29054935101300	M29054935105400
	2 1/2"	65	M29054935101400	M29054935105500

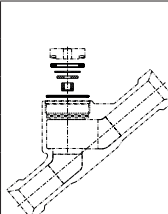
	Ø	DN	Spare parts kits no. 50-63-90-125 mm
			entry above the disc
	1/2"	15	M29054935100100
	3/4"	20	M29054935100200
	1"	25	M29054935100300
	1 1/4"	32	M29054935100400
	1 1/2"	40	M29054935100500
	2"	50	M29054935100600
	2 1/2"	65	M29054935100700

### Butt welding SMS 3018

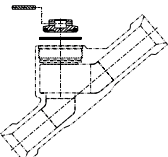
	Ø	DN	Spare parts kits no. 50-63-90-125 mm	
			entry under the disc	
			Normally Closed	Normally Open + Double Acting (bistable)
	1"	25	M29054935101000	M29054935103700
	1 1/4"	32	M29054935101100	M29054935105200
	1 1/2"	40	M29054935101200	M29054935105300
	2"	50	M29054935101300	M29054935105400

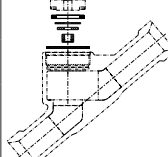
	Ø	DN	Spare parts kits no. 50-63-90-125 mm
			entry above the disc
	1"	25	M29054935100300
	1 1/4"	32	M29054935100400
	1 1/2"	40	M29054935100500
	2"	50	M29054935100600

### Butt welding DIN EN 10357-A (DIN 11850-S2)

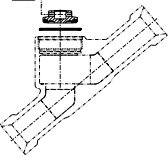
	Ø	DN	Spare parts kits no. 50-63-90-125 mm	
			entry under the disc	
			Normally Closed	Normally Open + Double Acting (bistable)
	1/2"	15	M29054935100800	M29054935103500
	3/4"	20	M29054935100900	M29054935103600
	1"	25	M29054935101000	M29054935103700
	1 1/4"	32	M29054935101100	M29054935105200
	1 1/2"	40	M29054935101200	M29054935105300
	2"	50	M29054935101300	M29054935105400

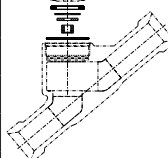
	Ø	DN	Spare parts kits no. 50-63-90-125 mm
			entry above the disc
	1/2"	15	M29054935100100
	3/4"	20	M29054935100200
	1"	25	M29054935100300
	1 1/4"	32	M29054935100400
	1 1/2"	40	M29054935100500
	2"	50	M29054935100600

### Butt welding ASME BPE

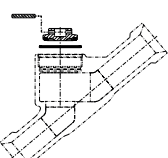
	Ø	DN	Spare parts kits no. 50-63-90-125 mm	
			entry under the disc	
			Normally Closed	Normally Open + Double Acting (bistable)
	1/2"	15	M29054935100800	M29054935103500
	3/4"	20	M29054935100900	M29054935103600
	1"	25	M29054935101000	M29054935103700
	1 1/2"	40	M29054935101200	M29054935105300
	2"	50	M29054935101300	M29054935105400

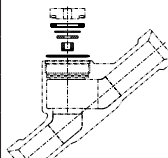
	Ø	DN	Spare parts kits no. 50-63-90-125 mm
			entry above the disc
	1/2"	15	M29054935100100
	3/4"	20	M29054935100200
	1"	25	M29054935100300
	1 1/2"	40	M29054935100500
	2"	50	M29054935100600

01537GB-2021/R01  
Availability, design and specifications are subject to change without notice. All rights reserved.

View showing the function / actuator / flow direction				
Plastic actuators				
32 mm actuator	50 mm actuator	63 mm actuator	90 mm actuator	125 mm actuator
<b>NC - Normally closed, entry under the disc</b>				
<b>NO - Normally open, entry under the disc</b>				
<b>NC - Normally closed, entry above the disc</b>				
<b>Bistable function</b>				

01537GB-2021/R01  
Availability, design and specifications are subject to change without notice. All rights reserved.



View showing the function / actuator / flow direction

Stainless steel actuators

32 mm actuator	50 mm actuator	63 mm actuator	90 mm actuator
<b>NC - Normally closed, entry under the disc</b>			
<b>NO - Normally open, entry under the disc</b>			
<b>NC - Normally closed, entry above the disc</b>			
<b>Bistable function</b>			
			-

01537GB-2021/R01  
Availability, design and specifications are subject to change without notice. All rights reserved.

**Selection of the minimum pilot pressure**

**NO - Normally open, entry under the disc**

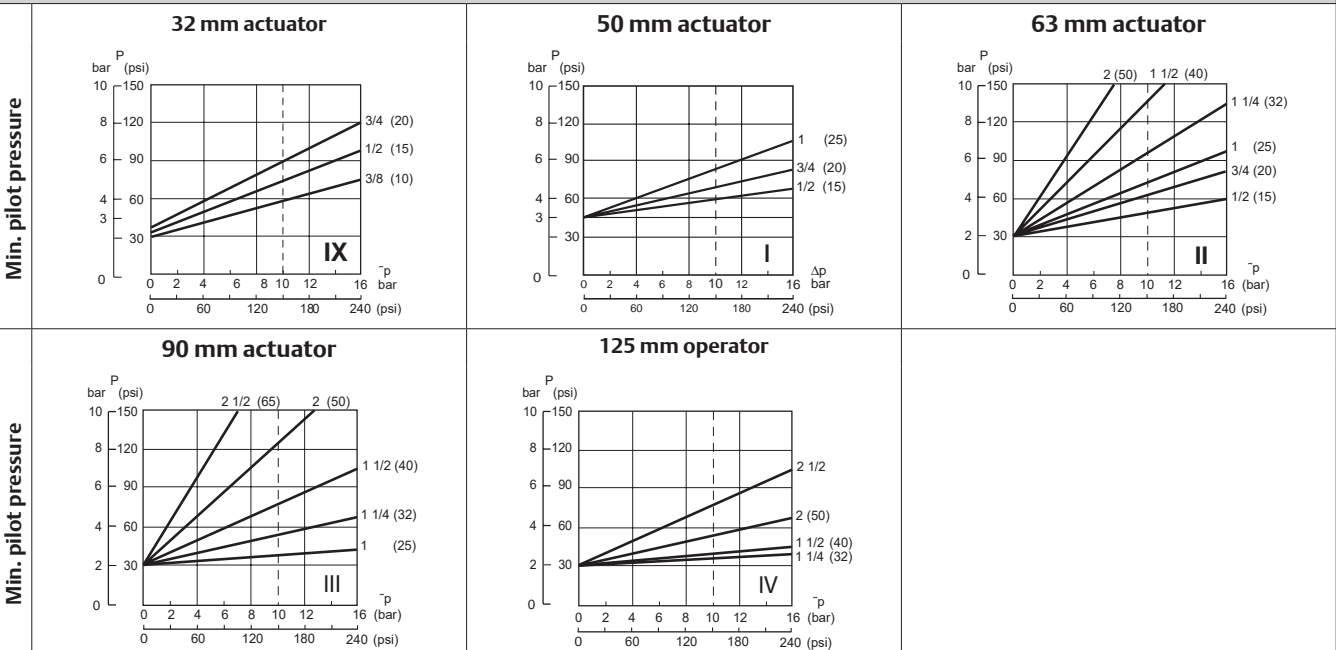

**NC - Normally closed, entry above the disc**

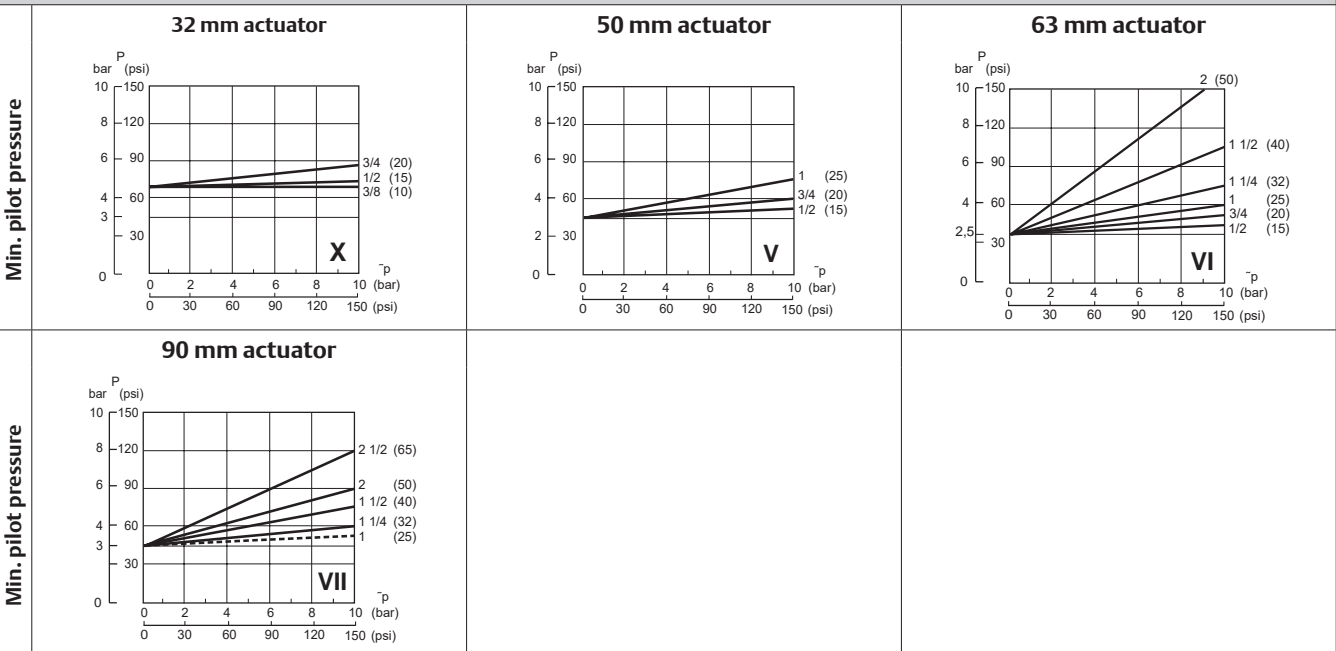

**Bistable function**

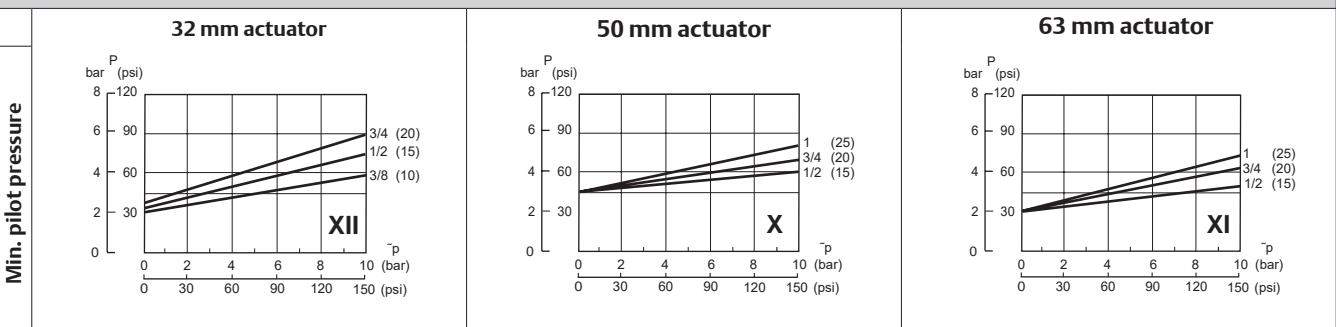

01537GB-2021/R01  
Availability, design and specifications are subject to change without notice. All rights reserved.

# ASCO™ Pneumatic Angle Seat Valves

## Installation

- Valves can be mounted in any position without affecting operation
- Possibility to interchange actuators (sizes/functions) on the same body
- Adjustable actuator enables 360° access to pilot port
- Compatible with ASTM 1, 2 and 3 oils
- Pilot thread connection (G) or (NPTF) or (NPT) has a standard thread according to ISO 228/1 or ANSI B 1.20.3 or ANSI B1.20.1
- Installation/maintenance instructions in multiple languages are available on our website

## Choice of options and accessories

Options	NC	NO	NC	-	Actuator diameter compatibility (mm)																																																																																																																																													
	Fluid entry under the disc	Fluid entry under the disc	Fluid entry above the disc	Bistable function	32	50	63	90	125																																																																																																																																									
	AT0	•	•	•	•	•	•	•	•	•	<p><b>ATEX/IECEx</b></p> <ul style="list-style-type: none"> <li>• 2/2 valves NC/NO designed for use in potentially explosive atmospheres in accordance with ATEX-Directive 2014/34/EU EC type examination certificate no.: <b>LCIE 20 ATEX 3037 X</b> IECEx Certificate of Conformity no.: <b>IECEx LCIE 20.0025X</b></li> <li>• Compliance with the Essential Health and Safety Requirements of the ATEX Directive has been assured by compliance with European Standards EN ISO 80079-36 and EN ISO 80079-37</li> <li>• Recommended for applications in the chemical, oil, gas and paint coating industries etc.</li> </ul> <p>ATEX-Directive 2014/34/EU, category 1</p> <table border="1"> <thead> <tr> <th colspan="6">Classification (zones) Category 1</th> </tr> <tr> <th colspan="3">Dusts</th> <th colspan="3">Gas</th> <th rowspan="2">Safety code</th> </tr> <tr> <th>IIIA</th> <th>IIIB</th> <th>IIIC</th> <th>IIA</th> <th>IIB</th> <th>IIC</th> </tr> </thead> <tbody> <tr> <td colspan="3">Zone 20</td> <td colspan="3">Zone 0</td> <td>                     ⓧ II 1G Ex h IIC T* Ga                      ⓧ II 1D Ex h IIIC T**C Da                 </td> </tr> <tr> <th colspan="2">1GD</th> <th colspan="2">Plastic actuator</th> <th colspan="2">Metallic actuator</th> </tr> <tr> <th>T*°C</th> <th>T*</th> <th>Ts amb</th> <th>T fluid</th> <th>Ts amb</th> <th>T fluid</th> </tr> <tr> <td>300°C</td> <td>T2</td> <td>-</td> <td>-</td> <td>80°C</td> <td>220°C</td> </tr> <tr> <td>200°C</td> <td>T3</td> <td>60°C</td> <td>145°C</td> <td>80°C</td> <td>149°C</td> </tr> <tr> <td>135°C</td> <td>T4</td> <td>60°C</td> <td>93°C</td> <td>80°C</td> <td>97°C</td> </tr> <tr> <td>100°C</td> <td>T5</td> <td>60°C</td> <td>65°C</td> <td>70°C</td> <td>69°C</td> </tr> <tr> <td>85°C</td> <td>T6</td> <td>60°C</td> <td>53°C</td> <td>60°C</td> <td>57°C</td> </tr> </tbody> </table> <p>ATEX-Directive 2014/34/EU, category 2</p> <table border="1"> <thead> <tr> <th colspan="6">Classification (zones) Category 2</th> </tr> <tr> <th colspan="3">Dusts</th> <th colspan="3">Gas</th> <th rowspan="2">Safety code</th> </tr> <tr> <th>IIIA</th> <th>IIIB</th> <th>IIIC</th> <th>IIA</th> <th>IIB</th> <th>IIC</th> </tr> </thead> <tbody> <tr> <td colspan="3">Zone 21</td> <td colspan="3">Zone 1</td> <td>                     ⓧ II 2G Ex h IIC T* Gb X                      ⓧ II 2D Ex h IIIC T**C Db X                 </td> </tr> <tr> <th colspan="2">2GD</th> <th colspan="2">Plastic actuator</th> <th colspan="2">Metallic actuator</th> </tr> <tr> <th>T*°C</th> <th>T*</th> <th>Ts amb</th> <th>T fluid</th> <th>Ts amb</th> <th>T fluid</th> </tr> <tr> <td>300°C</td> <td>T2</td> <td>-</td> <td>-</td> <td>80°C</td> <td>220°C</td> </tr> <tr> <td>200°C</td> <td>T3</td> <td>60°C</td> <td>180°C</td> <td>80°C</td> <td>184°C</td> </tr> <tr> <td>135°C</td> <td>T4</td> <td>60°C</td> <td>115°C</td> <td>80°C</td> <td>119°C</td> </tr> <tr> <td>100°C</td> <td>T5</td> <td>60°C</td> <td>80°C</td> <td>70°C</td> <td>80°C</td> </tr> <tr> <td>85°C</td> <td>T6</td> <td>60°C</td> <td>60°C</td> <td>60°C</td> <td>60°C</td> </tr> </tbody> </table> <p>                     T*°C = Surface temperature                      T* = Temperature class                      Ts amb = Ambient temperature                      T fluid = Fluid temperature                 </p>	Classification (zones) Category 1						Dusts			Gas			Safety code	IIIA	IIIB	IIIC	IIA	IIB	IIC	Zone 20			Zone 0			ⓧ II 1G Ex h IIC T* Ga ⓧ II 1D Ex h IIIC T**C Da	1GD		Plastic actuator		Metallic actuator		T*°C	T*	Ts amb	T fluid	Ts amb	T fluid	300°C	T2	-	-	80°C	220°C	200°C	T3	60°C	145°C	80°C	149°C	135°C	T4	60°C	93°C	80°C	97°C	100°C	T5	60°C	65°C	70°C	69°C	85°C	T6	60°C	53°C	60°C	57°C	Classification (zones) Category 2						Dusts			Gas			Safety code	IIIA	IIIB	IIIC	IIA	IIB	IIC	Zone 21			Zone 1			ⓧ II 2G Ex h IIC T* Gb X ⓧ II 2D Ex h IIIC T**C Db X	2GD		Plastic actuator		Metallic actuator		T*°C	T*	Ts amb	T fluid	Ts amb	T fluid	300°C	T2	-	-	80°C	220°C	200°C	T3	60°C	180°C	80°C	184°C	135°C	T4	60°C	115°C	80°C	119°C	100°C	T5	60°C	80°C	70°C	80°C	85°C	T6	60°C	60°C	60°C
Classification (zones) Category 1																																																																																																																																																		
Dusts			Gas			Safety code																																																																																																																																												
IIIA	IIIB	IIIC	IIA	IIB	IIC																																																																																																																																													
Zone 20			Zone 0			ⓧ II 1G Ex h IIC T* Ga ⓧ II 1D Ex h IIIC T**C Da																																																																																																																																												
1GD		Plastic actuator		Metallic actuator																																																																																																																																														
T*°C	T*	Ts amb	T fluid	Ts amb	T fluid																																																																																																																																													
300°C	T2	-	-	80°C	220°C																																																																																																																																													
200°C	T3	60°C	145°C	80°C	149°C																																																																																																																																													
135°C	T4	60°C	93°C	80°C	97°C																																																																																																																																													
100°C	T5	60°C	65°C	70°C	69°C																																																																																																																																													
85°C	T6	60°C	53°C	60°C	57°C																																																																																																																																													
Classification (zones) Category 2																																																																																																																																																		
Dusts			Gas			Safety code																																																																																																																																												
IIIA	IIIB	IIIC	IIA	IIB	IIC																																																																																																																																													
Zone 21			Zone 1			ⓧ II 2G Ex h IIC T* Gb X ⓧ II 2D Ex h IIIC T**C Db X																																																																																																																																												
2GD		Plastic actuator		Metallic actuator																																																																																																																																														
T*°C	T*	Ts amb	T fluid	Ts amb	T fluid																																																																																																																																													
300°C	T2	-	-	80°C	220°C																																																																																																																																													
200°C	T3	60°C	180°C	80°C	184°C																																																																																																																																													
135°C	T4	60°C	115°C	80°C	119°C																																																																																																																																													
100°C	T5	60°C	80°C	70°C	80°C																																																																																																																																													
85°C	T6	60°C	60°C	60°C	60°C																																																																																																																																													
AT1	•	•	•	•	•	•	•	•	•	<p><b>ATEX/IECEx</b></p> <p><b>EAC</b> <b>Ex</b></p>																																																																																																																																								

When a combination of several options are selected (using the product configurator on our website) you will be provided with a specific combination code

01537GB-2021/R01  
Availability, design and specifications are subject to change without notice. All rights reserved.



# ASCO™ Pneumatic Angle Seat Valves

Dimensions mm (inches), Weight kg (Lbs) 

Configurator - CAD Files

**TYPE 01**  
32 mm actuator / Plastic actuator  
Fluid entry:  
under the disc at 2  
above the disc at 1

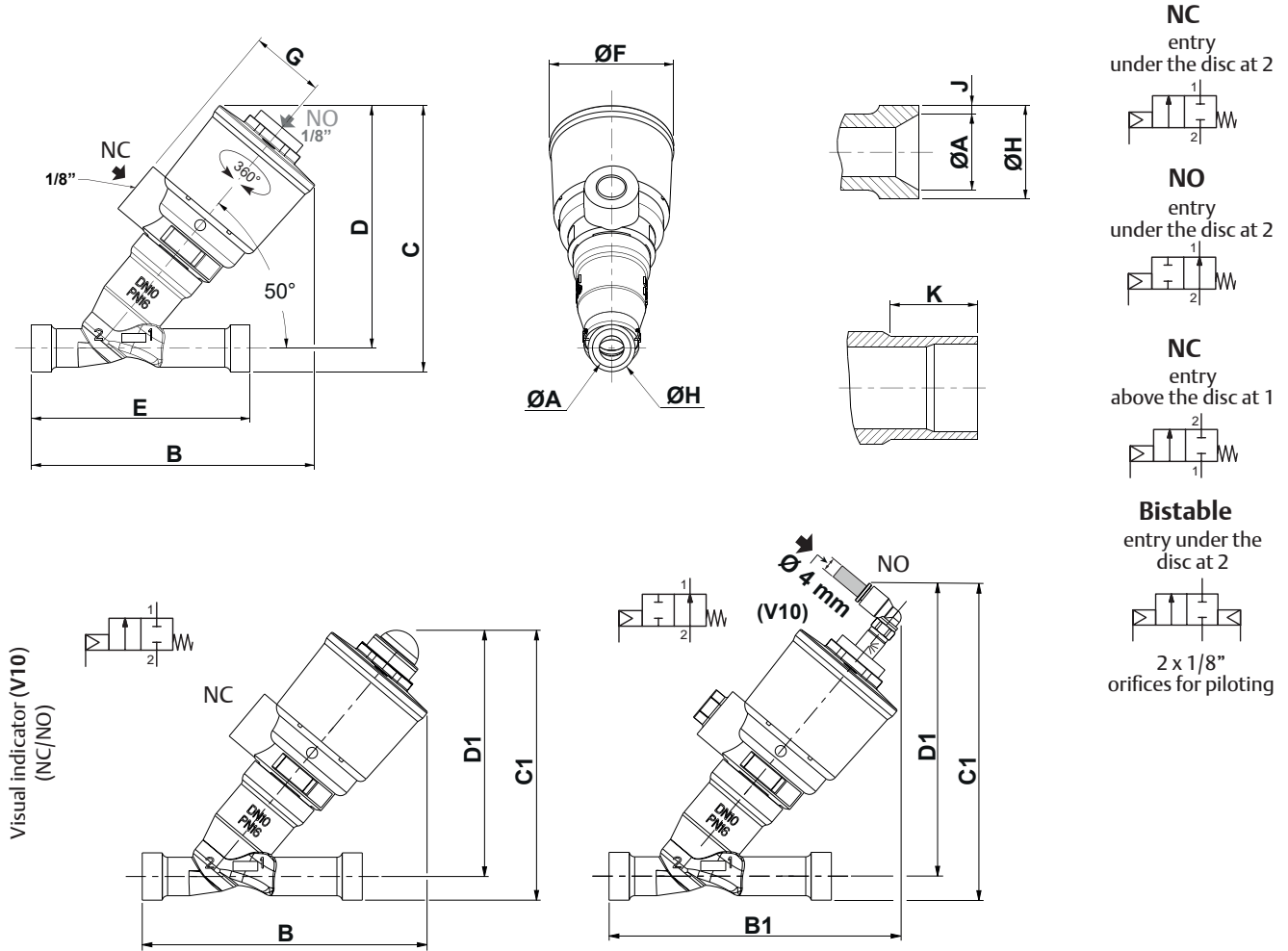
Type	Ø (mm)	DN	ØA		B		B1 (V10)		C		C1 (V10)				D					
			ISO	BPE	ISO	BPE	ISO	BPE	ISO	BPE	ISO		BPE		ISO	BPE				
			NC	NO	NC	NO	NC	NO	NC	NO	NC	NO	NC	NO	ISO	BPE				
01	32	10	mm	14	7.75	103.5	103.5	104.5	104.5	97.5	94.5	98.5	115	95.5	112	89	89			
			(in)	0.551	0.305	4.075	4.075	4.114	4.114	3.839	3.720	3.878	4.528	3.760	4.409	3.504	3.504			
		15	mm	18.1	9.4	103	103.5	104	104.5	100.5	95.5	101.5	118	96.5	113	90	88.5			
			(in)	0.713	0.370	4.055	4.075	4.094	4.114	3.957	3.760	3.996	4.646	3.799	4.449	3.543	3.484			
		20	mm	23.7	15.75	105	103	106	104	103.5	100	104.5	121	101	117.5	89.5	89.5			
			(in)	0.933	0.620	4.134	4.055	4.173	4.094	4.075	3.937	4.114	4.764	3.976	4.626	3.524	3.524			
					D1 (V10)				E		ØF	G	ØH		J		K	Weight <sup>(1)</sup>		
					ISO		BPE		ISO	BPE			ISO	BPE	ISO	BPE				
					NC	NO	NC	NO											ISO	BPE
				10	mm	90	106	90	106	80	80	46	27	17.2	9.53	1.6	0.89	8	0.3	kg
					(in)	3.539	4.189	3.543	4.173	3.150	3.150	1.811	1.063	0.677	0.375	0.063	0.035	0.315	0.7	(Lbs)
				15	mm	91	107	89.5	106	84	80	46	27	21.3	12.7	1.6	1.65	10	0.4	kg
			(in)	3.577	4.226	3.524	4.173	3.307	3.150	1.811	1.063	0.839	0.500	0.063	0.065	0.394	0.9	(Lbs)		
		20	mm	91	107	91	107	94	84	46	27	26.9	19.05	1.6	1.65	7	0.5	kg		
			(in)	3.585	4.213	3.583	4.213	3.701	3.307	1.811	1.063	1.059	0.750	0.063	0.065	0.276	1.1	(Lbs)		

<sup>(1)</sup> Weight of valve without pilot.  
For solenoid pilot valve, see dedicated catalog pages.

01537GB-2021/R01  
Availability, design and specifications are subject to change without notice. All rights reserved.

**Dimensions mm (inches), Weight kg (Lbs)**

Configurator - CAD Files



**TYPE 01**  
32 mm actuator / Stainless steel actuator  
Fluid entry:  
under the disc at 2  
above the disc at 1

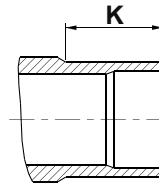
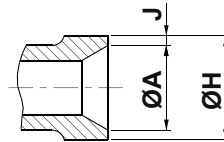
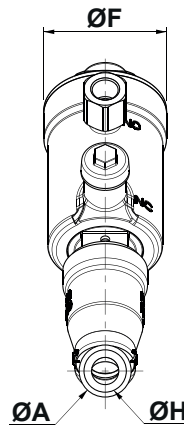
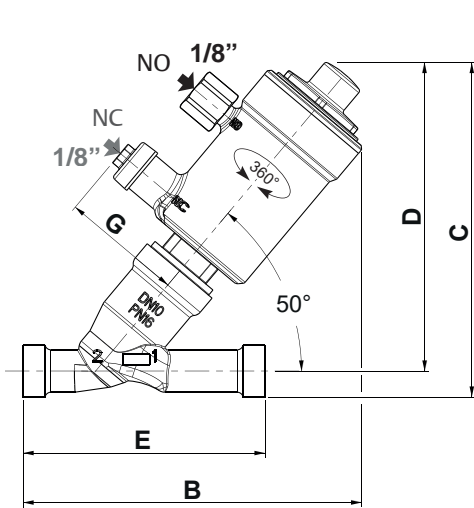

**NC**  
entry  
under the disc at 2

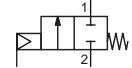

**NO**  
entry  
under the disc at 2

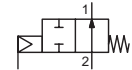

**NC**  
entry  
above the disc at 1

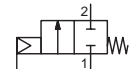

**Bistable**  
entry under the  
disc at 2

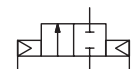

2 x 1/8"  
orifices for piloting

Type	Ø (mm)	DN	ØA		B		C		D		Weight <sup>(1)</sup>					
			ISO	BPE	ISO	BPE	ISO	BPE	ISO	BPE						
01	32	10	mm	14	7.75	112	112	110.5	108	102	102					
			(in)	0.551	0.305	4.409	4.409	4.350	4.252	4.016	4.016					
		15	mm	18.1	9.4	111.5	112	114	109	103	102					
			(in)	0.713	0.370	4.390	4.409	4.488	4.291	4.055	4.016					
		20	mm	23.7	15.75	113	111.5	117	113	103	103					
			(in)	0.933	0.620	4.449	4.390	4.606	4.449	4.055	4.055					
	32	10		E		ØF	G	ØH		J		K				
				ISO	BPE			ISO	BPE	ISO	BPE					
		15			mm	80	80	41	40	17.2	9.53	1.6	0.89	8	0.6	kg
					(in)	3.150	3.150	1.614	1.575	0.677	0.375	0.063	0.035	0.315	1.3	(Lbs)
		20			mm	84	80	41	40	21.3	12.7	1.6	1.65	10	0.6	kg
					(in)	3.307	3.150	1.614	1.575	0.839	0.500	0.063	0.065	0.394	1.3	(Lbs)
20			mm	94	84	41	40	26.9	19.05	1.6	1.65	7	0.7	kg		
			(in)	3.701	3.307	1.614	1.575	1.059	0.750	0.063	0.065	0.276	1.5	(Lbs)		

<sup>(1)</sup> Weight of valve without pilot.  
For solenoid pilot valve, see dedicated catalog pages.

# ASCO™ Pneumatic Angle Seat Valves

Dimensions mm (inches), Weight kg (Lbs)

Configurator - CAD Files



**TYPE 02**  
50 mm actuator / Plastic actuator  
Fluid entry:  
under the disc at 2  
above the disc at 1

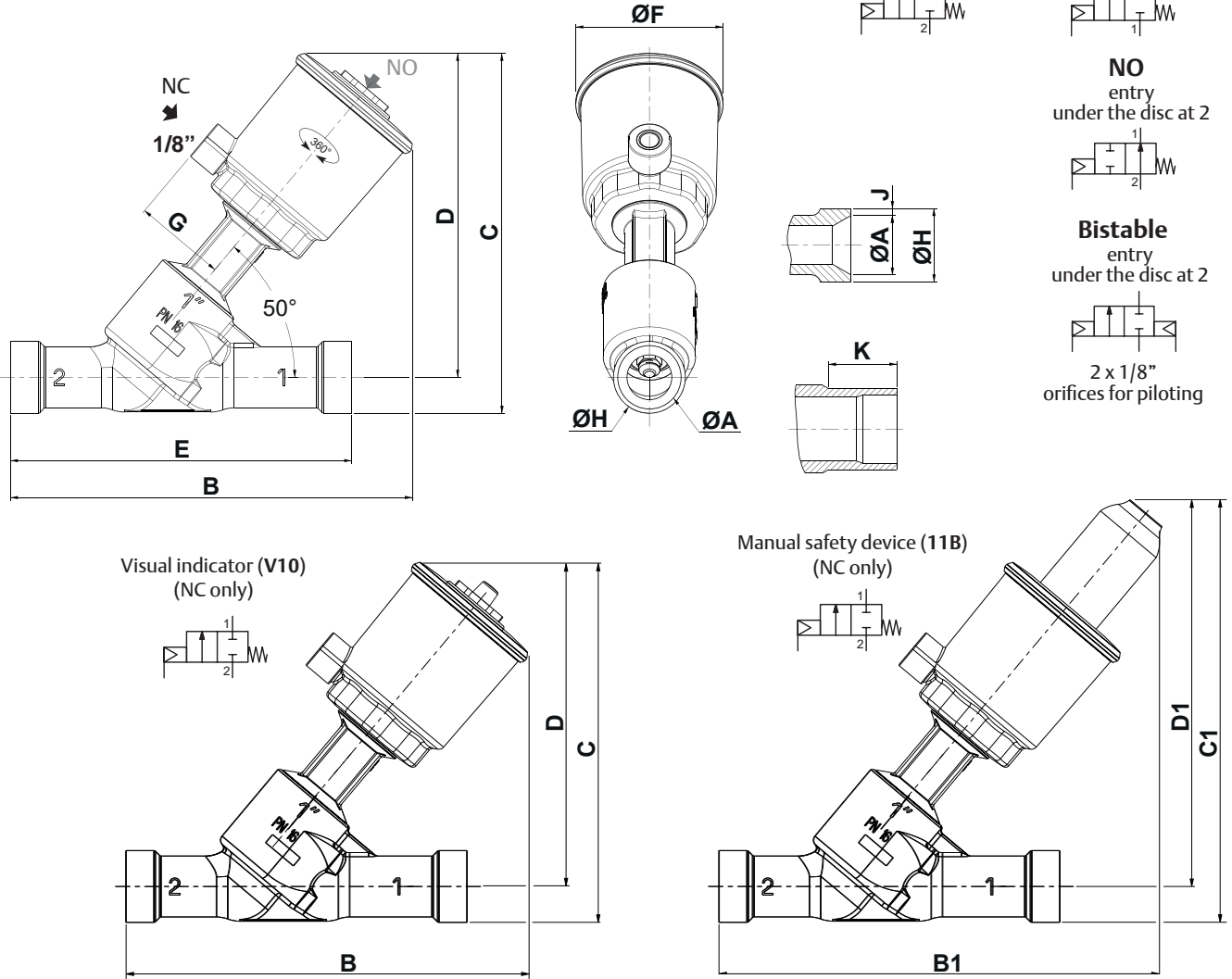

Type	Ø (mm)	DN	ØA				B	B1 (11B)	C				C1 (11B)				D	D1 (11B)	
			ISO	BPE	SMS	DIN			ISO	BPE	SMS	DIN	ISO	BPE	SMS	DIN			
02	50	15	mm	18.1	9.4	-	16	168.5	189	154	151	-	154	185	182	-	185	143.5	174.5
			(in)	0.713	0.370	-	0.630	6.634	7.441	6.063	5.945	-	6.063	7.283	7.165	-	7.283	5.650	6.870
		20	mm	23.7	15.75	-	20	168.5	189	157.5	156.5	-	156.5	188.5	187.5	-	187.5	144	175
			(in)	0.933	0.620	-	0.787	6.634	7.441	6.201	6.161	-	6.161	7.421	7.382	-	7.382	5.669	6.890
		25	mm	29.7	22.1	22.6	26	188.5	209	168.5	168.5	168.5	168.5	199.5	199.5	199.5	199.5	152	183
			(in)	1.169	0.870	0.890	1.024	7.421	8.228	6.634	6.634	6.634	6.634	7.854	7.854	7.854	7.854	5.984	7.205
	50	15	E	ØF	G	ØH				J				K				Weight <sup>(1)</sup>	
						ISO	BPE	SMS	DIN	ISO	BPE	SMS	DIN	BPE	SMS	DIN			
		15	mm	130	69	43	21.3	12.7	-	19	1.6	1.65	-	1.5	9	-	16	0.8	kg
			(in)	5.118	2.717	1.693	0.839	0.500	-	0.748	0.063	0.065	-	0.059	0.354	-	0.630	1.8	(Lbs)
		20	mm	150	69	43	26.9	19.05	-	23	1.6	1.65	-	1.5	14.5	-	16	1.1	kg
			(in)	5.906	2.717	1.693	1.059	0.750	-	0.906	0.063	0.065	-	0.059	0.571	-	0.630	2.4	(Lbs)
25	mm	160	69	43	33.7	25.4	25	29	2	1.65	1.2	1.5	16	16	-	1.3	kg		
	(in)	6.299	2.717	1.693	1.327	1.000	0.984	1.142	0.079	0.065	0.047	0.059	0.630	0.630	-	2.9	(Lbs)		

<sup>(1)</sup> Weight of valve without pilot.  
For solenoid pilot valve, see dedicated catalog pages.

01537GB-2021/R01  
Availability, design and specifications are subject to change without notice. All rights reserved.

**Dimensions mm (inches), Weight kg (Lbs)**

Configurator - CAD Files



**TYPE 02**  
50 mm actuator / Stainless steel actuator  
Fluid entry:  
under the disc at 2  
above the disc at 1

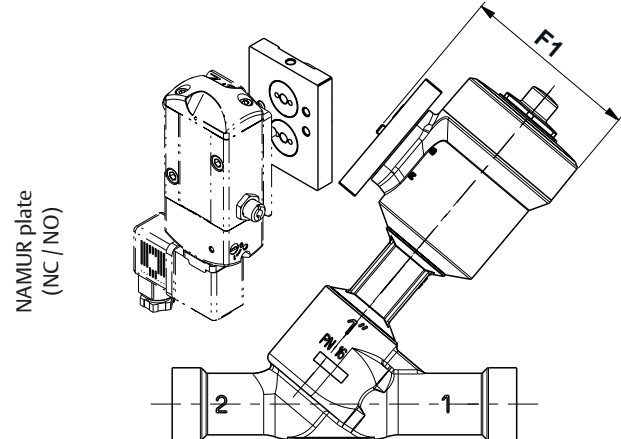
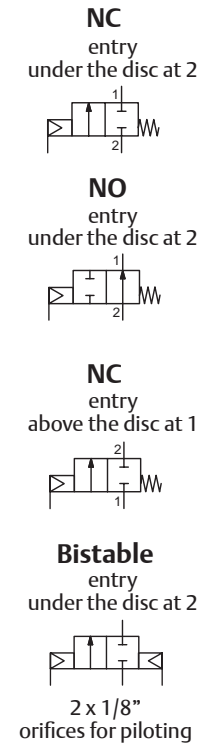
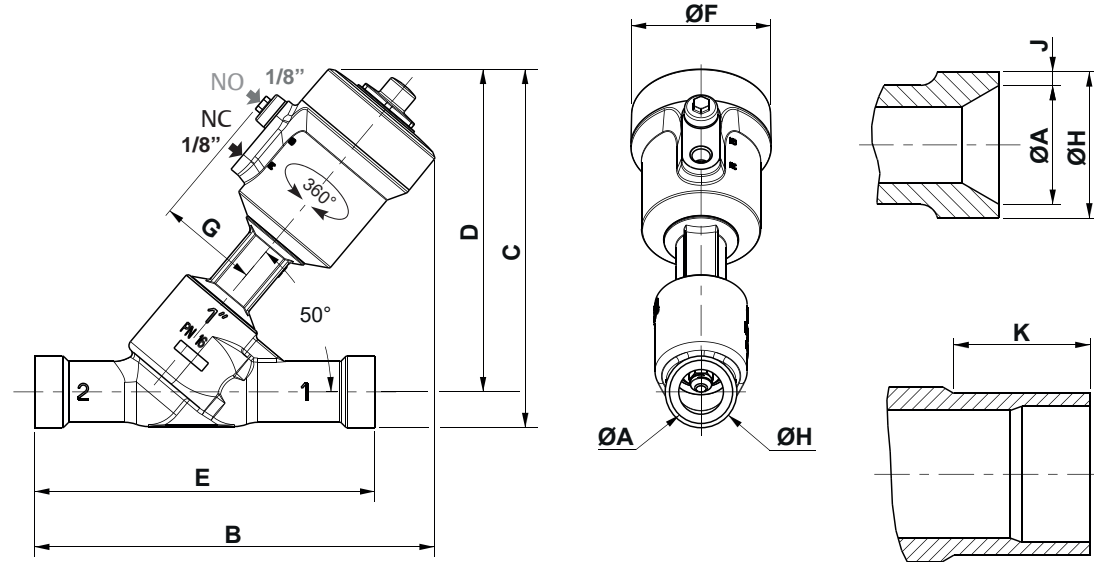

Type	Ø (mm)	DN	ØA				B	C				D	E	ØF	F1 (NAMUR)						
			ISO	BPE	SMS	DIN		ISO	BPE	SMS	DIN										
02	50	15	mm	18.1	9.4	-	16	168	154	151	-	153.5	143.5	130	65.5	82					
			(in)	0.713	0.370	-	0.630	6.614	6.063	5.945	-	6.043	5.650	5.118	2.579	3.228					
		20	mm	23.7	15.75	-	20	168.5	157	156.5	-	156.5	144	150	65.5	82					
			(in)	0.933	0.620	-	0.787	6.634	6.181	6.161	-	6.161	5.669	5.906	2.579	3.228					
		25	mm	29.7	22.1	22.6	26	188	168.5	168	168	168	168	160	65.5	82					
			(in)	1.169	0.870	0.890	1.024	7.402	6.634	6.614	6.614	6.614	5.984	6.299	2.579	3.228					
					15	G				ØH				J				K			Weight <sup>(1)</sup>
						ISO	BPE	SMS	DIN	ISO	BPE	SMS	DIN	BPE	SMS	DIN	kg				
					mm	47	21.3	12.7	-	19	1.6	1.65	-	1.5	9	-	16	1.3	kg		
						(in)	1.850	0.839	0.500	-	0.748	0.063	0.065	-	0.059	0.354	-	0.630	2.9	(Lbs)	
					mm	47	26.9	19.05	-	23	1.6	1.65	-	1.5	14.5	-	16	1.6	kg		
						(in)	1.850	1.059	0.750	-	0.906	0.063	0.065	-	0.059	0.571	-	0.630	3.5	(Lbs)	
mm	47				33.7	25.4	25	29	2	1.65	1.2	1.5	16	16	-	1.7	kg				
	(in)				1.850	1.327	1.000	0.984	1.142	0.079	0.065	0.047	0.059	0.630	0.630	-	3.7	(Lbs)			

<sup>(1)</sup> Weight of valve without pilot.  
For solenoid pilot valve, see dedicated catalog pages.

01537GB-2021/RO1  
Availability, design and specifications are subject to change without notice. All rights reserved.



# ASCO™ Pneumatic Angle Seat Valves

Dimensions mm (inches), Weight kg (Lbs)

Configurator - CAD Files



**TYPE 03**

63 mm actuator / Plastic actuator

Fluid entry:  
under the disc at 2  
above the disc at 1

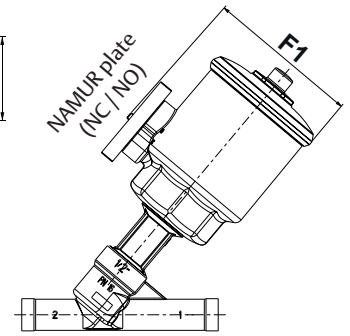
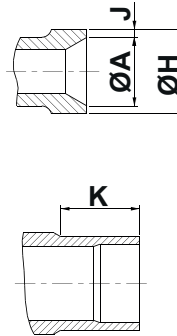
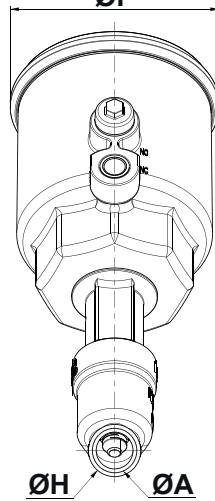
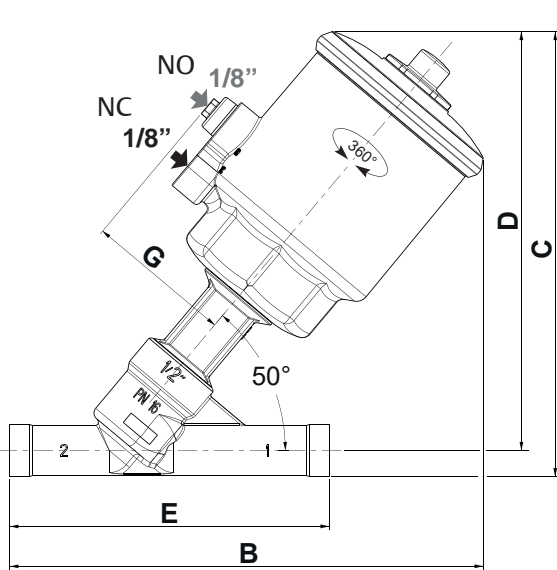
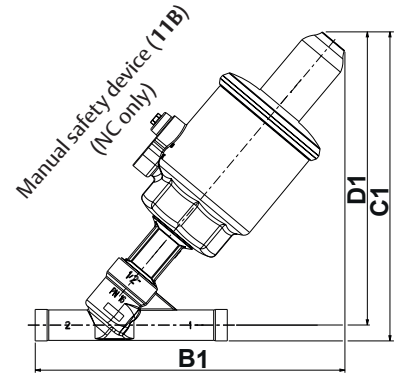
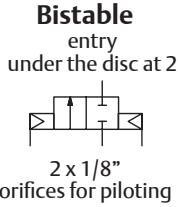
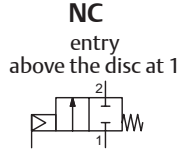
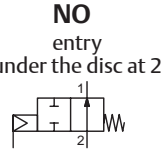
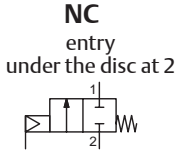

Type	DN	Ø (mm)	ØA				B	B1 (11B)	C				C1 (11B)				D	D1 (11B)	E	
			ISO	BPE	SMS	DIN			ISO	BPE	SMS	DIN	ISO	BPE	SMS	DIN				
03	63	15	mm	18.1	9.4	-	16	193	210.5	181	178.5	-	181	209.5	207	-	209.5	170.5	199	130
		(in)	0.713	0.370	-	0.630	7.598	8.287	7.126	7.028	-	7.126	8.248	8.150	-	8.248	6.713	7.835	5.118	
		20	mm	23.7	15.75	-	20	193	210.5	184.5	184	-	184	213	212.5	-	212.5	171	199.5	150
		(in)	0.933	0.620	-	0.787	7.598	8.287	7.264	7.244	-	7.244	8.386	8.366	-	8.366	6.732	7.854	5.906	
		25	mm	29.7	22.1	22.6	26	213	230.5	196	196	196	196	224.5	224.5	-	224.5	179	207.5	160
		(in)	1.169	0.870	0.890	1.024	8.386	9.075	7.717	7.717	7.717	7.717	8.839	8.839	-	8.839	7.047	8.169	6.299	
	32	mm	38.4	-	31.3	32	235	252.5	212.5	-	210.5	210.5	241	-	239	239	191	219.5	180	
	(in)	1.512	-	1.232	1.260	9.252	9.941	8.366	-	8.287	8.287	9.488	-	9.409	9.409	7.520	8.642	7.087		
	40	mm	44.3	35	35.6	38	237	254.5	217.5	217.5	217.5	217.5	246	246	246	246	192.5	221	200	
	(in)	1.744	1.370	1.402	1.496	9.331	10.02	8.563	8.563	8.563	8.563	9.685	9.685	9.685	9.685	7.579	8.701	7.874		
	50	mm	56.3	47.5	48.6	50	268	285.5	229.5	229.5	229.5	229.5	258	258	258	258	199	227.5	230	
	(in)	2.217	1.870	1.913	1.969	10.551	11.24	9.035	9.035	9.035	9.035	10.157	10.157	10.157	10.157	7.835	8.957	9.055		
03	63	15	mm	ØF	F1 (NAMUR)	G	ØH				ØJ				K				Weight <sup>(1)</sup>	
			(in)	3.346	4.094	2.343	0.839	0.500	-	0.748	0.063	0.065	-	0.059	-	0.354	-	0.630		2.2
		20	mm	85	104	59.5	21.3	12.7	-	19	1.6	1.65	-	1.5	-	9	-	16	1.0	kg
			(in)	3.346	4.094	2.343	1.059	0.750	-	0.906	0.063	0.065	-	0.059	-	0.571	-	0.630	2.9	(Lbs)
		25	mm	85	104	59.5	26.9	19.05	-	23	1.6	1.65	-	1.5	-	14.5	-	16	1.3	kg
			(in)	3.346	4.094	2.343	1.327	1.000	0.984	1.142	0.079	0.065	0.047	0.059	-	0.630	0.630	-	3.3	(Lbs)
		32	mm	85	104	59.5	33.7	25.4	25	29	2	1.65	1.2	1.5	-	16	16	-	1.5	kg
			(in)	3.346	4.094	2.343	1.327	1.000	0.984	1.142	0.079	0.065	0.047	0.059	-	0.630	0.630	-	3.3	(Lbs)
		40	mm	85	104	59.5	42.4	-	33.7	35	2	-	1.2	1.5	-	8	16	-	2.0	kg
			(in)	3.346	4.094	2.343	1.669	-	1.327	1.378	0.079	-	0.047	0.059	-	0.315	0.630	-	4.4	(Lbs)
		50	mm	85	104	59.5	48.3	38.1	38	41	2	1.65	1.2	1.5	8	8	7	16	2.9	kg
			(in)	3.346	4.094	2.343	1.902	1.500	1.496	1.614	0.079	0.065	0.047	0.059	0.315	0.315	0.276	0.630	6.4	(Lbs)
50	mm	85	104	59.5	60.3	50.8	51	53	2	1.65	1.2	1.5	-	7	7	16	3.7	kg		
	(in)	3.346	4.094	2.343	2.374	2.000	2.008	2.087	0.079	0.065	0.047	0.059	-	0.276	0.276	0.630	8.2	(Lbs)		

<sup>(1)</sup> Weight of valve without pilot.  
For solenoid pilot valve, see dedicated catalog pages.

**Dimensions mm (inches), Weight kg (Lbs)**



**TYPE 03**  
63 mm actuator / Stainless steel actuator  
Fluid entry:  
under the disc at 2  
above the disc at 1

Configurator - CAD Files

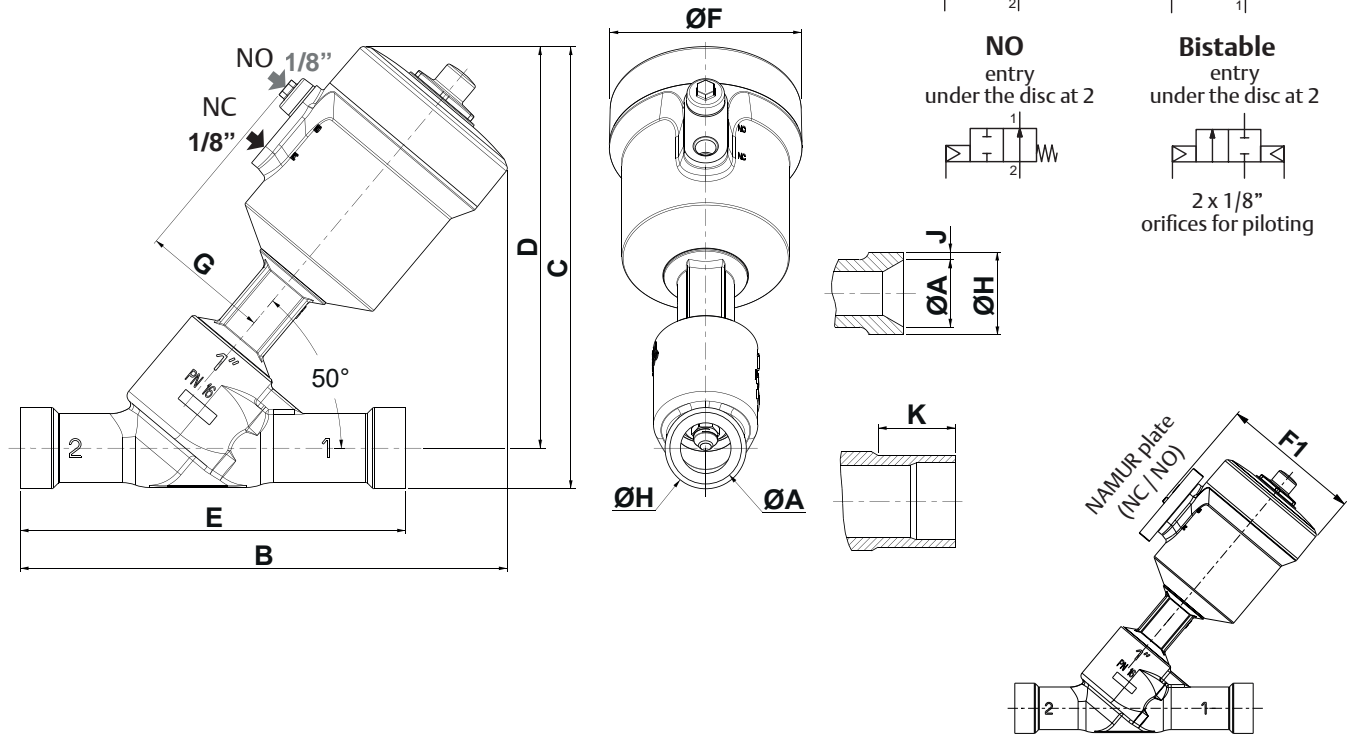
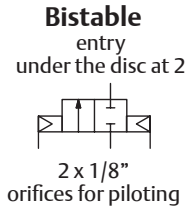
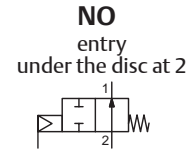
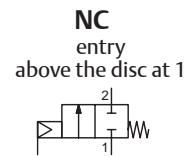
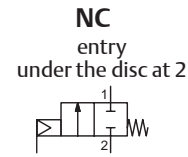

Type	Ø (mm)	DN	ØA				B	C				D	E	ØF	F1 (NAMUR)	G	
			ISO	BPE	SMS	DIN		ISO	BPE	SMS	DIN						
03	63	15	mm	18.1	9.4	-	16	182	169	166	-	168.5	158.5	130	79.5	95	53
			(in)	0.713	0.370	-	0.630	7.165	6.654	6.535	-	6.634	6.240	5.118	3.130	3.740	2.087
		20	mm	23.7	15.75	-	20	182.5	172	171.5	-	171.5	159	150	79.5	95	53
			(in)	0.933	0.620	-	0.787	7.185	6.772	6.752	-	6.752	6.260	5.906	3.130	3.740	2.087
		25	mm	29.7	22.1	22.6	26	202.5	183.5	183	183	183	167	160	79.5	95	53
			(in)	1.169	0.870	0.890	1.024	7.972	7.224	7.205	7.205	7.205	6.575	6.299	3.130	3.740	2.087
		32	mm	38.4	-	31.3	32	224.5	199.5	-	198	198	178.5	180	79.5	95	53
			(in)	1.512	-	1.232	1.260	8.839	7.854	-	7.795	7.795	7.028	7.087	3.130	3.740	2.087
		40	mm	44.3	35	35.6	38	226.5	205.5	-	205.5	205.5	180.5	200	79.5	95	53
			(in)	1.744	1.370	1.402	1.496	8.917	8.091	-	8.091	8.091	7.106	7.874	3.130	3.740	2.087
		50	mm	56.3	47.5	48.6	50	257.5	217	217	217	217	187	230	79.5	95	53
			(in)	2.217	1.870	1.913	1.969	10.138	8.543	8.543	8.543	8.543	7.362	9.055	3.130	3.740	2.087
03	63	15	ØH				J				K				Weight <sup>(1)</sup>		
			ISO	BPE	SMS	DIN	ISO	BPE	SMS	DIN	ISO	BPE	SMS	DIN			
		15	mm	21.3	12.7	-	19	1.6	1.65	-	1.5	-	9	-	16	1.8	kg
			(in)	0.839	0.500	-	0.748	0.063	0.065	-	0.059	-	0.354	-	0.630	4.0	(Lbs)
		20	mm	26.9	19.05	-	23	1.6	1.65	-	1.5	-	14.5	-	16	2.1	kg
			(in)	1.059	0.750	-	0.906	0.063	0.065	-	0.059	-	0.571	-	0.630	4.6	(Lbs)
		25	mm	33.7	25.4	25	29	2	1.65	1.2	1.5	-	16	16	-	2.2	kg
			(in)	1.327	1.000	0.984	1.142	0.079	0.065	0.047	0.059	-	0.630	0.630	-	4.9	(Lbs)
		32	mm	42.4	-	33.7	35	2	-	1	2	-	-	8	16	2.7	kg
			(in)	1.669	-	1.327	1.378	0.079	-	0.047	0.059	-	-	0.315	0.630	6.0	(Lbs)
		40	mm	48.3	-	38	41	2	-	1	2	8	-	7	16	3.6	kg
			(in)	1.902	-	1.496	1.614	0.079	-	0.047	0.059	0.315	-	0.276	0.630	7.9	(Lbs)
50	mm	60.3	50.8	51	53	2	1.65	1.2	1.5	-	7	7	16	4.4	kg		
	(in)	2.374	2.000	2.008	2.087	0.079	0.065	0.047	0.059	-	0.276	0.276	0.630	9.7	(Lbs)		

<sup>(1)</sup> Weight of valve without pilot.  
For solenoid pilot valve, see dedicated catalog pages.

# ASCO™ Pneumatic Angle Seat Valves

Dimensions mm (inches), Weight kg (Lbs)

Configurator - CAD Files



**TYPE 04**  
90 mm actuator / Plastic actuator  
Fluid entry:  
under the disc at 2  
above the disc at 1

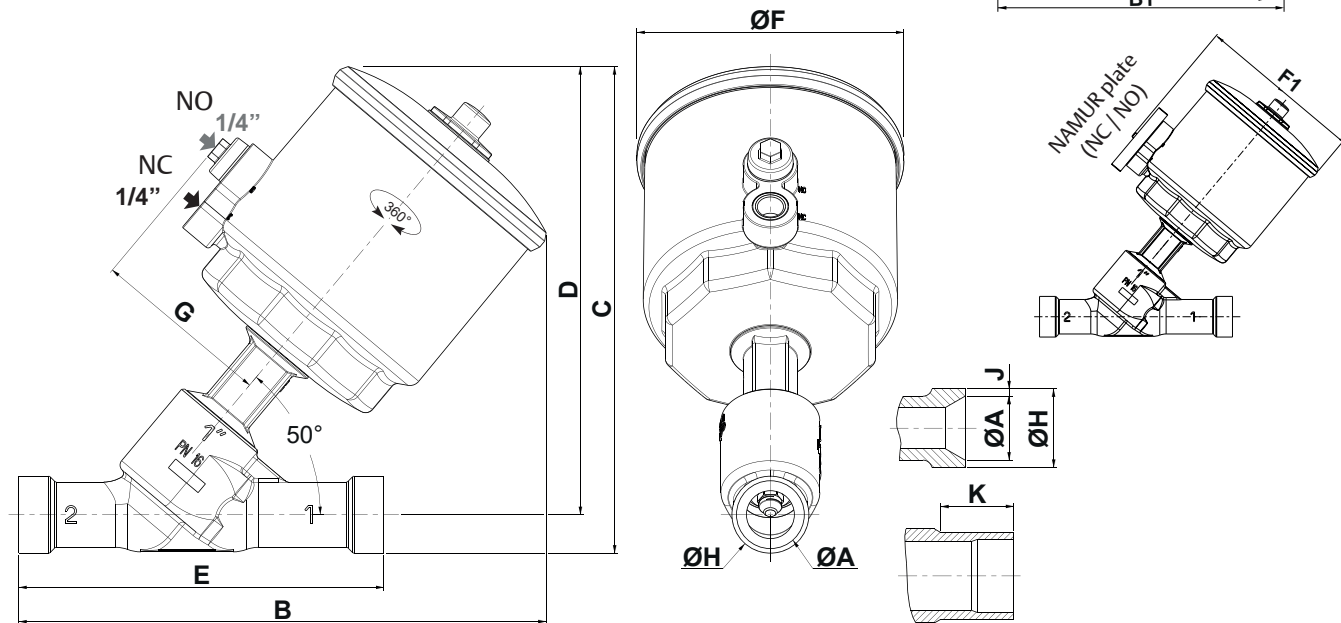
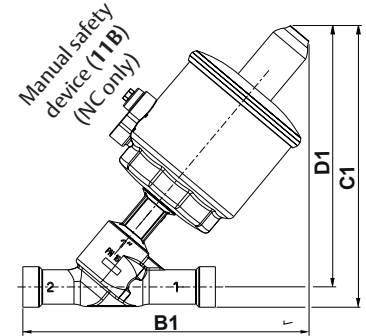
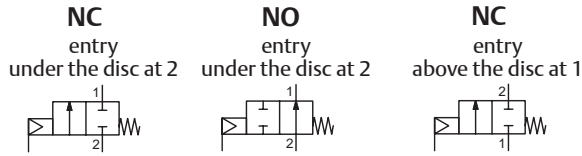

Type	DN	ØA				B	B1 (11B)	C				C1 (11B)				D	D1 (11B)	E		
		ISO	BPE	SMS	DIN			ISO	BPE	SMS	DIN	ISO	BPE	SMS	DIN					
04	25	mm	29.7	22.1	22.6	26	231	237.5	213	212.5	212.5	212.5	233	232.5	232.5	232.5	196.5	216.5	160	
		(in)	1.169	0.870	0.890	1.024	9.094	9.350	8.386	8.366	8.366	8.366	9.173	9.154	9.154	9.154	7.736	8.524	6.299	
	32	mm	38.4	-	31.3	32	253.5	260	229	-	228	228	249	-	248	248	208	228	180	
		(in)	1.512	-	1.232	1.260	9.980	10.236	9.016	-	8.976	8.976	9.803	-	9.764	9.764	8.189	8.976	7.087	
	40	mm	44.3	34.8	35.6	38	255.5	262	235	235	235	235	255	255	255	255	210	230	200	
		(in)	1.744	1.370	1.402	1.496	10.059	10.315	9.252	9.252	9.252	9.252	10.039	10.039	10.039	10.039	8.268	9.055	7.874	
	50	mm	56.3	47.5	48.6	50	286.5	293	246.5	246.5	246.5	246.5	266.5	266.5	266.5	266.5	216.5	236.5	230	
		(in)	2.217	1.870	1.913	1.969	11.280	11.535	9.705	9.705	9.705	9.705	10.492	10.492	10.492	10.492	8.524	9.311	9.055	
	65	mm	72.1	-	-	-	326.5	333	268.5	-	-	-	288.5	-	-	-	229.5	249.5	290	
		(in)	2.839	-	-	-	12.854	13.110	10.571	-	-	-	11.358	-	-	-	9.035	9.823	11.417	
	90	25	mm	117	137	78.5	33.7	25.4	25	29	2	1.65	1.2	1.5	-	16	16	-	2.1	kg
			(in)	4.606	5.394	3.091	1.327	1.000	0.984	1.142	0.079	0.065	0.047	0.059	-	0.630	0.630	-	4.6	(Lbs)
32		mm	117	137	78.5	42.4	-	33.7	35	2	-	1	2	-	-	8	16	2.6	kg	
		(in)	4.606	5.394	3.091	1.669	-	1.327	1.378	0.079	-	0.047	0.059	-	-	0.315	0.630	5.7	(Lbs)	
40		mm	117	137	78.5	48.3	38.1	38	41	2	2	1	2	8	8	7	16	3.5	kg	
		(in)	4.606	5.394	3.091	1.902	1.500	1.496	1.614	0.079	0.065	0.047	0.059	0.315	0.315	0.276	0.630	7.7	(Lbs)	
50		mm	117	137	78.5	60.3	50.8	51	53	2	1.65	1.2	1.5	-	7	7	16	4.3	kg	
		(in)	4.606	5.394	3.091	2.374	2.000	2.008	2.087	0.079	0.065	0.047	0.059	-	0.276	0.276	0.630	9.5	(Lbs)	
65		mm	117	137	78.5	76.1	-	-	-	2	-	-	-	9.5	-	-	-	6.4	kg	
		(in)	4.606	5.394	3.091	2.996	-	-	-	0.079	-	-	-	0.374	-	-	-	14.1	(Lbs)	

<sup>(1)</sup> Weight of valve without pilot.  
For solenoid pilot valve, see dedicated catalog pages.

01537GB-2021/R01 Availability, design and specifications are subject to change without notice. All rights reserved.

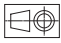
**Dimensions mm (inches), Weight kg (Lbs)** 

Configurator - CAD Files



**TYPE 04**  
90 mm actuator / Stainless steel actuator  
Fluid entry:  
under the disc at 2  
above the disc at 1

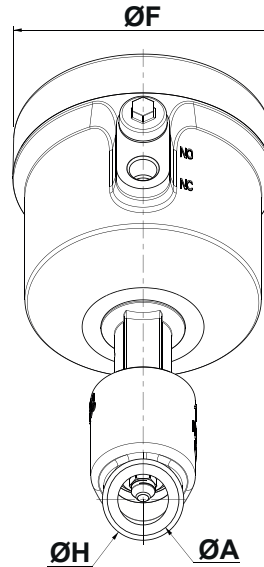
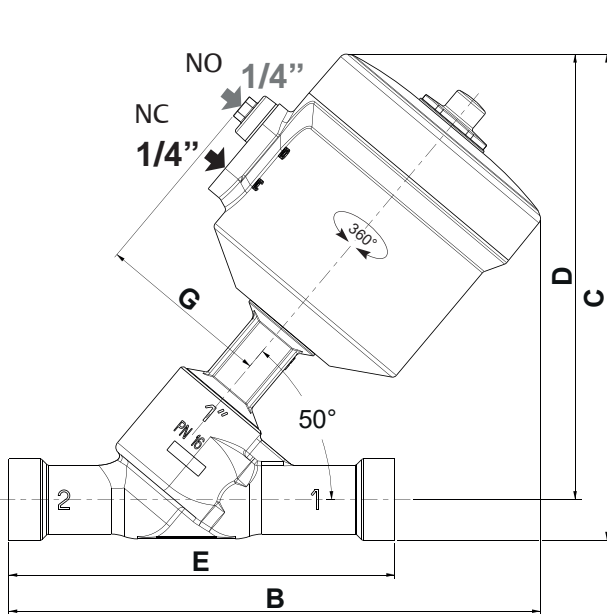
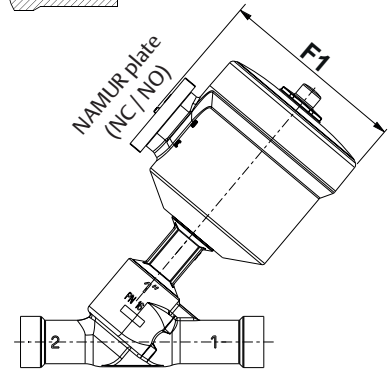
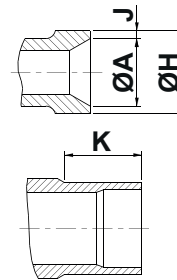
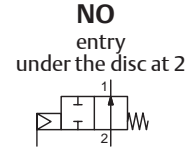
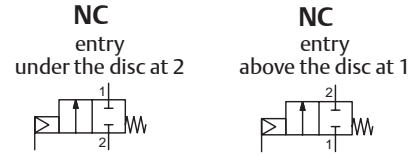

Type	Ø (mm)	DN	ØA				B	C				D	E	ØF	F1 (NAMUR)	G	
			ISO	BPE	SMS	DIN		ISO	BPE	SMS	DIN						
04	90	25	mm	29.7	22.1	22.6	26	220.5	201.5	201	201	201	185	160	108	126	72
			(in)	1.169	0.870	0.890	1.024	8.681	7.933	7.913	7.913	7.913	7.283	6.299	4.252	4.961	2.835
		32	mm	38.4	-	31.3	32	243	217.5	-	216	216	196.5	180	108	126	72
			(in)	1.512	-	1.232	1.260	9.567	8.563	-	8.504	8.504	7.736	7.087	4.252	4.961	2.835
		40	mm	44.3	34.8	35.6	38	245	223.5	223.5	223.5	223.5	198.5	200	108	126	72
			(in)	1.744	1.370	1.402	1.496	9.646	8.799	8.799	8.799	8.799	7.815	7.874	4.252	4.961	2.835
		50	mm	56.3	47.5	48.6	50	276	235	235	235	235	205	230	108	126	72
			(in)	2.217	1.870	1.913	1.969	10.866	9.252	9.252	9.252	9.252	8.071	9.055	4.252	4.961	2.835
		65	mm	72.1	-	-	-	316	257	-	-	-	218	290	108	126	72
			(in)	2.839	-	-	-	12.441	10.118	-	-	-	8.583	11.417	4.252	4.961	2.835
		04	90	25	ØH				J				K				Weight <sup>(1)</sup>
					ISO	BPE	SMS	DIN	ISO	BPE	SMS	DIN	ISO	BPE	SMS	DIN	
25	mm			33.7	25.4	25	29	2	1.65	1.2	1.5	-	16	16	-	3.3	kg
	(in)			1.327	1.000	0.984	1.142	0.079	0.065	0.047	0.059	-	0.630	0.630	-	7.3	(Lbs)
32	mm			42.4	-	33.7	35	2	-	1	2	-	-	8	16	3.7	kg
	(in)			1.669	-	1.327	1.378	0.079	-	0.047	0.059	-	-	0.315	0.630	8.2	(Lbs)
40	mm			48.3	38.1	38	41	2	2	1	2	8	8	7	16	4.7	kg
	(in)			1.902	1.500	1.496	1.614	0.079	0.065	0.047	0.059	0.315	0.315	0.276	0.630	10.4	(Lbs)
50	mm			60.3	50.8	51	53	2	1.65	1.2	1.5	-	7	7	16	5.4	kg
	(in)			2.374	2.000	2.008	2.087	0.079	0.065	0.047	0.059	-	0.276	0.276	0.630	11.9	(Lbs)
65	mm			76.1	-	-	-	2	-	-	-	9.5	-	-	-	7.5	kg
	(in)			2.996	-	-	-	0.079	-	-	-	0.374	-	-	-	16.5	(Lbs)

<sup>(1)</sup> Weight of valve without pilot.  
For solenoid pilot valve, see dedicated catalog pages.

# ASCO™ Pneumatic Angle Seat Valves

Dimensions mm (inches), Weight kg (Lbs) 



**TYPE 05**  
125 mm actuator / Plastic actuator  
Fluid entry:  
under the disc at 2

Configurator - CAD Files

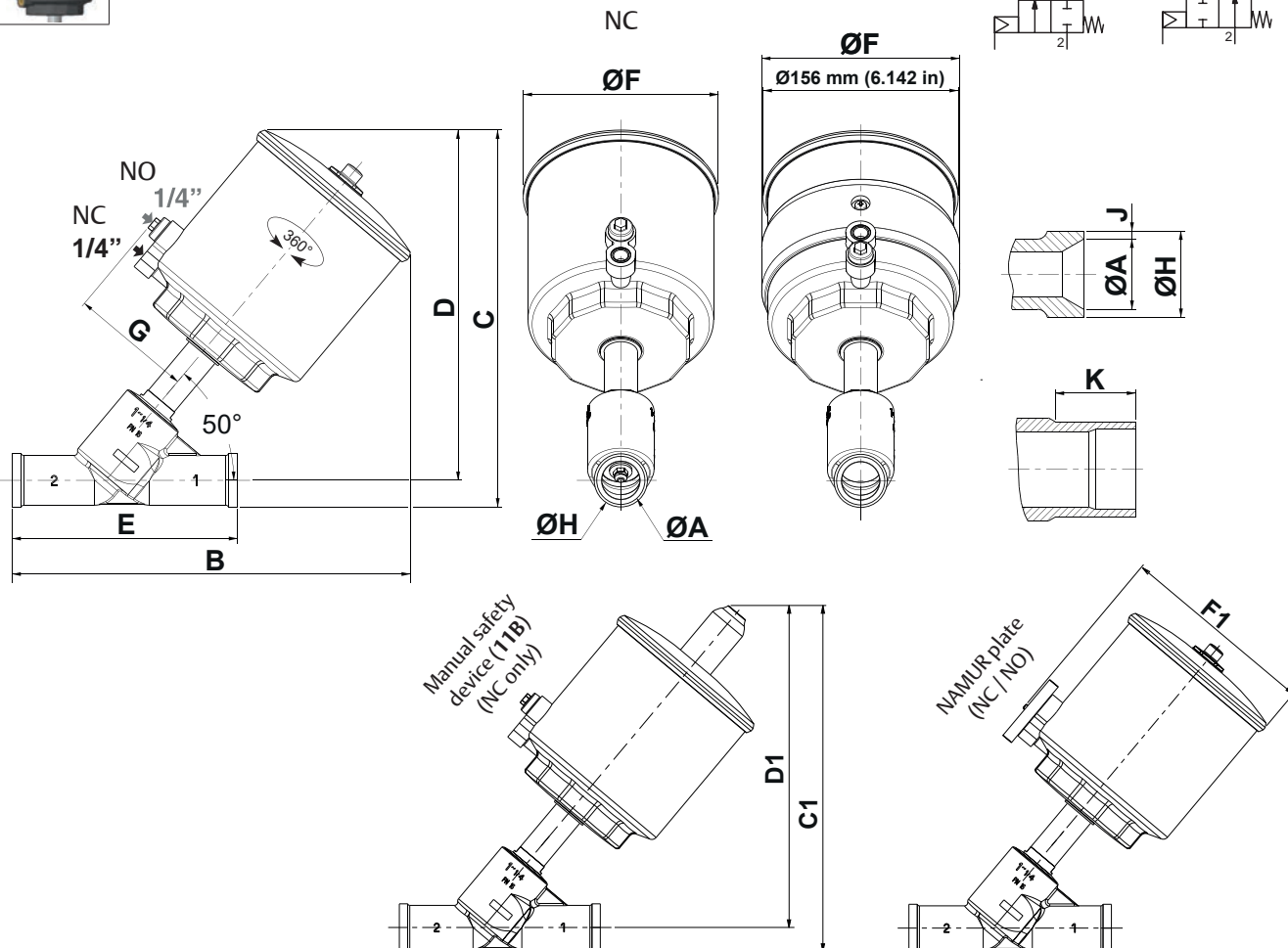
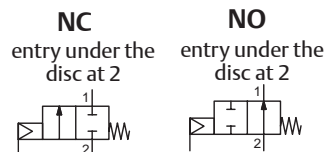

Type	DN	Ø (mm)	ØA				B	C				C1 (11 B)				D	D1 (11B)	E	ØF	
			ISO	BPE	SMS	DIN		ISO	BPE	SMS	DIN	ISO	BPE	SMS	DIN				NC	NO
05 125	32	mm	38.4	-	31.3	32	318	301	-	299.5	299.5	309.5	-	308	308	279.5	288	180	156	158
		(in)	1.512	-	1.232	1.260	12.520	11.850	-	11.791	11.791	12.185	-	12.126	12.126	11.004	11.339	7.087	6.142	6.220
	40	mm	44.3	34.8	35.6	38	321	308	308	308	308	316.5	317	317	283	291.5	200	156	158	
		(in)	1.744	1.370	1.402	1.496	12.638	12.126	12.126	12.126	12.126	12.461	12.461	12.461	11.142	11.476	7.874	6.142	6.220	
	50	mm	56.3	47.5	48.6	50	353.5	321.5	321.5	321.5	321.5	330	330	330	330	291	299.5	230	156	158
		(in)	2.217	1.870	1.913	1.969	13.917	12.657	12.657	12.657	12.657	12.992	12.992	12.992	11.457	11.791	9.055	6.142	6.220	
	65	mm	72.1	-	-	-	396	346.5	-	-	-	355	-	-	-	307.5	316	290	156	158
		(in)	2.839	-	-	-	15.591	13.642	-	-	-	13.976	-	-	-	12.106	12.441	11.417	6.142	6.220
	05 125	32	mm	175	97	42.4	-	33.7	35	2	-	1	2	-	-	8	16	5.6		kg
			(in)	6.890	3.819	1.669	-	1.327	1.378	0.079	-	0.047	0.059	-	-	0.315	0.630	12.3		(Lbs)
		40	mm	175	97	48.3	38.1	38	41	2	2	1	2	8	8	7	16	6.7		kg
			(in)	6.890	3.819	1.902	1.500	1.496	1.614	0.079	0.065	0.047	0.059	0.315	0.315	0.276	0.630	14.8		(Lbs)
50		mm	175	97	60.3	50.8	51	53	2	1.65	1.2	1.5		7	7	16	7.6		kg	
		(in)	6.890	3.819	2.374	2.000	2.008	2.087	0.079	0.065	0.047	0.059		0.276	0.276	0.630	16.8		(Lbs)	
65		mm	175	97	76.1	-	-	-	2	-	-	-	9.5	-	-	-	9.9		kg	
		(in)	6.890	3.819	2.996	-	-	-	0.079	-	-	-	0.374	-	-	-	21.8		(Lbs)	

<sup>(1)</sup> Weight of valve without pilot.  
For solenoid pilot valve, see dedicated catalog pages.

01537GB-2021/R01  
Availability, design and specifications are subject to change without notice. All rights reserved.

